



CURATED BY
LONDON GATE

ABOUT DEVELOPER

Founded in 2006 by Mr. Ghaleb Al Sarraj, Al Serh Al Kabeer Construction Company L.L.C. is a trusted leader in construction and property development across the UAE and Saudi Arabia. With expertise spanning residential, commercial, and specialized projects, the company is driven by a commitment to excellence and innovation, backed by a highly qualified team with global and local experience.



ASAK REAL ESTATE
DEVELOPMENT L.L.C



ABOUT ASAK 11

This modern development offers a total of 105 units, including studios, one-bedroom apartments, two-bedroom apartments, and retail spaces. The design features sleek lines, expansive glass windows, and lush greenery, creating a visually appealing and eco-friendly environment. Each unit is spacious, with large balconies and high-end finishes, while ample parking ensures convenience for both residents and visitors.

A woman with long brown hair and a young girl are lying on their stomachs on a light-colored, shaggy rug in a living room. The woman is holding a white tablet and both are smiling and looking at the screen. In the background, there is a grey sofa and a window with light-colored curtains. The scene is warmly lit, suggesting a cozy indoor environment.

WHERE LIFE'S
BEST MOMENTS
HAPPEN



ABOUT JUMEIRAH VILLAGE CIRCLE

Jumeirah Village Circle (JVC) in the heart of new Dubai offers a prime location with great connectivity to various parts of the emirate, making it a sought-after destination for both renters and buyers looking for affordable apartments and villas. Its popularity among investors is further boosted by its freehold status, competitive prices, and attractive rental yields.

Nakheel, the master developer behind JVC, has crafted a community known for its tranquil ambiance, complemented by lush gardens, parks, and a range of amenities. This blend of serene surroundings and modern conveniences makes JVC an attractive option for those seeking a balanced lifestyle in Dubai.



THE HEARTBEAT
OF FAMILY LIFE

THE LOCATION

02 Minutes
JSS International School

05 Minutes
Circle Mall

07 Minutes
Aster Clinic

10 Minutes
Dubai Miracle Garden

12 Minutes
City Centre Me'aisem

15 Minutes
Dubai Hills Mall

16 Minutes
Dubai Autodrome

18 Minutes
Global Village

20 Minutes
IMG Worlds of Adventure

30 Minutes
Jumeirah Beach

35 Minutes
Dubai International Airport

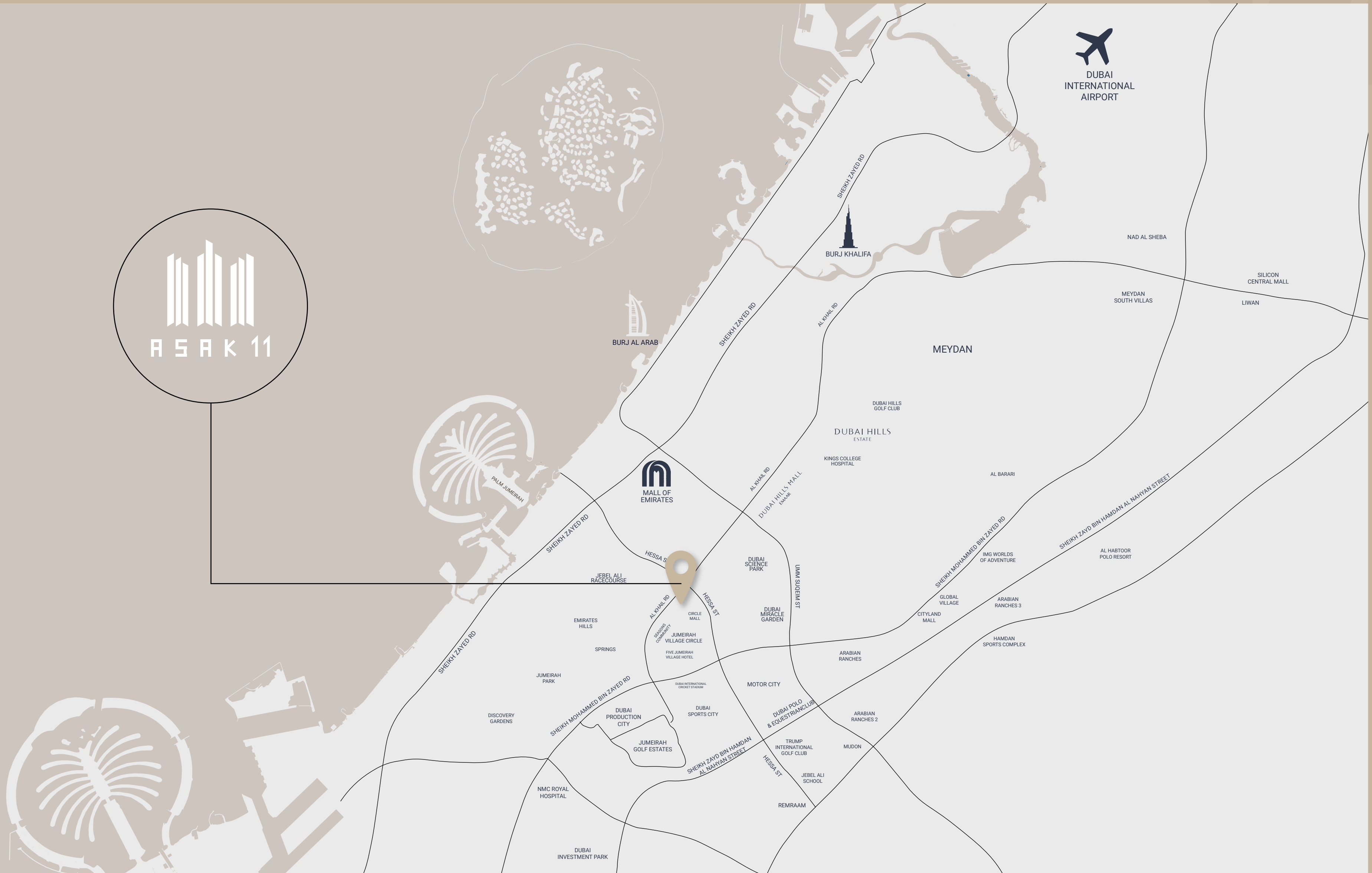

PLOT LOCATION





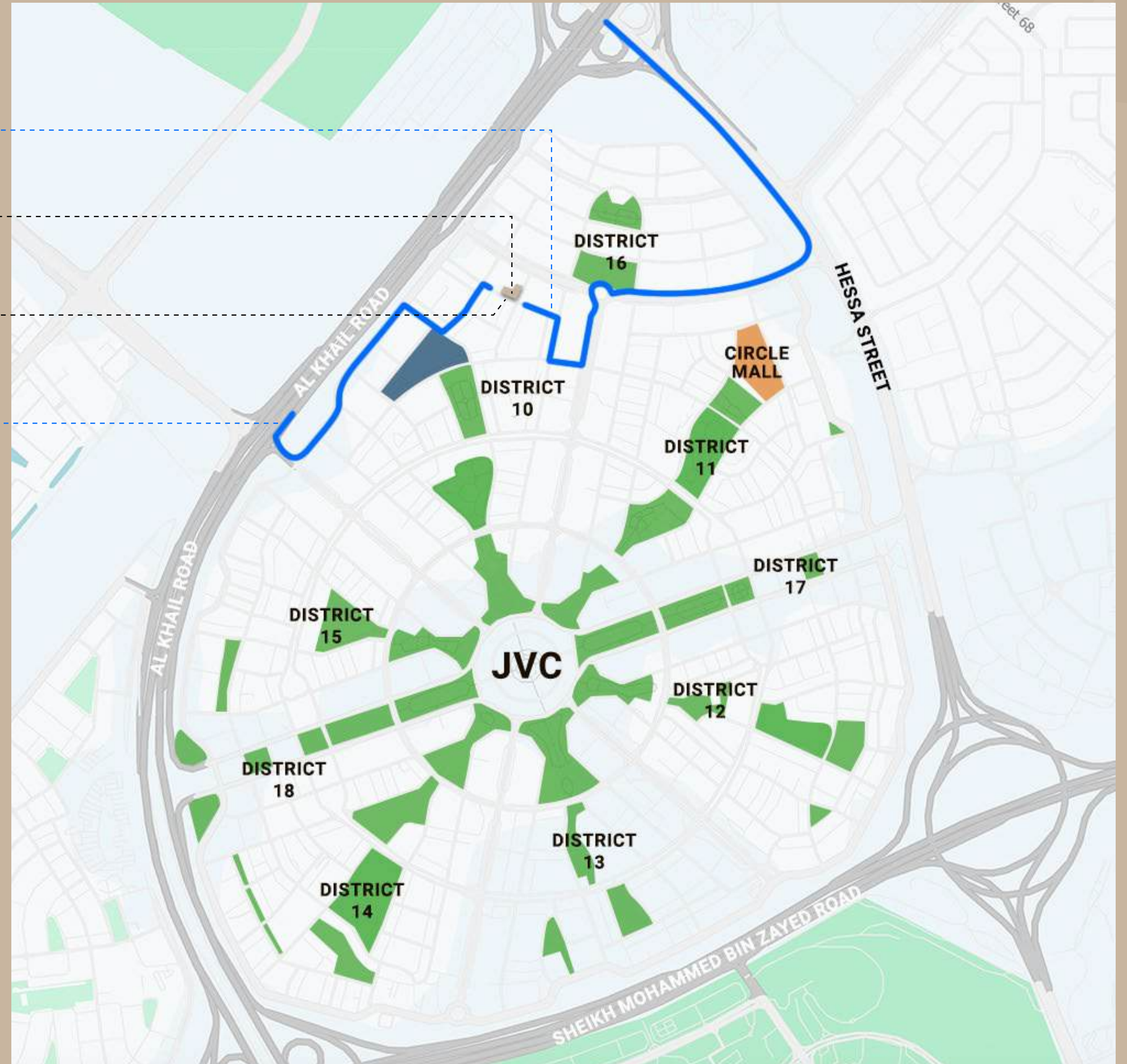

EXIT FROM JVC

BUILDING ENTRY

ENTRY TO JVC



-  PARKS
-  CIRCLE MALL
-  ROAD ACCESS
-  JSS INTERNATIONAL SCHOOL

FACADE



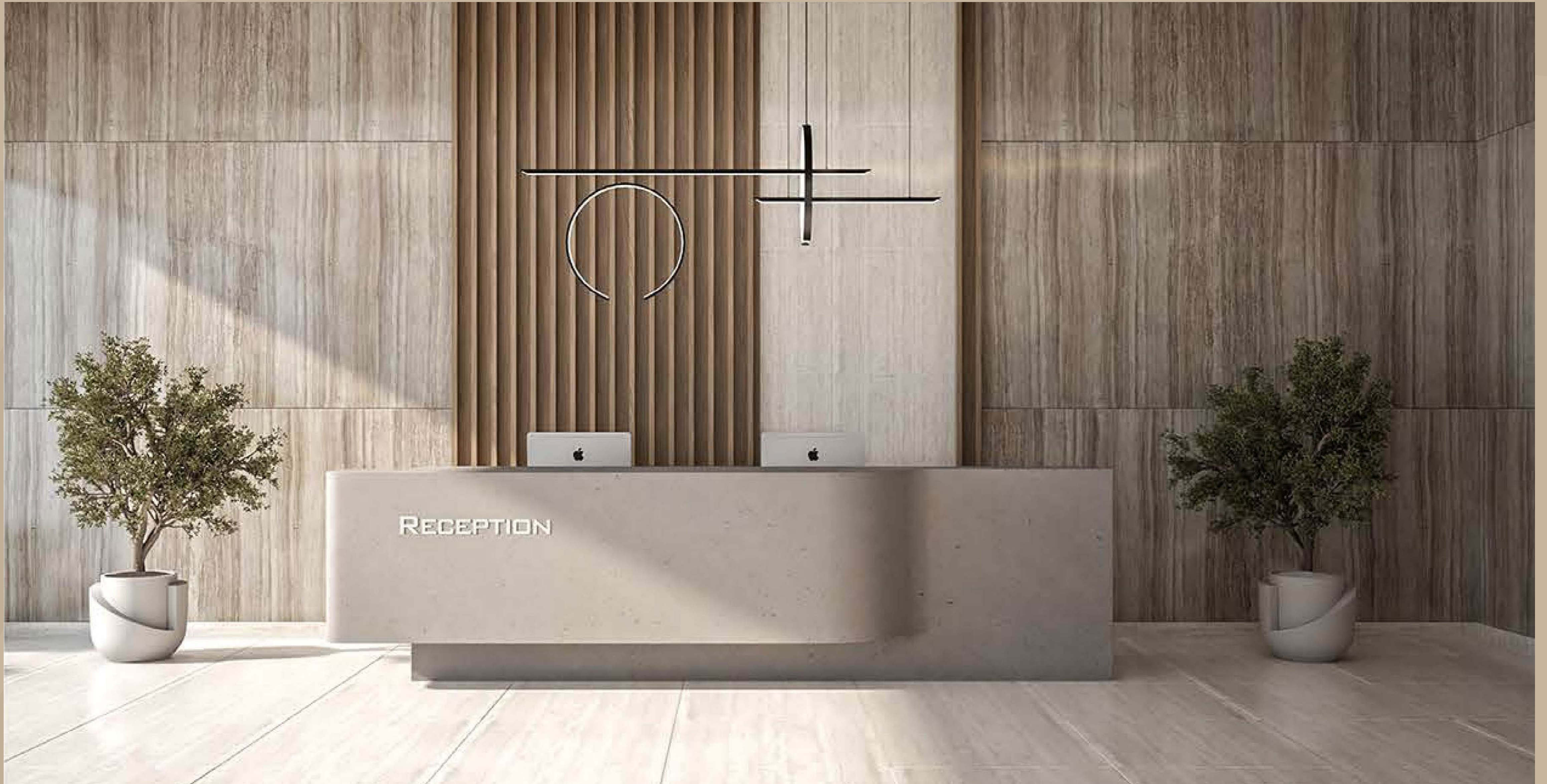

LIVING ROOM



KITCHEN



BEDROOM



BATHROOM



PODIUM LOUNGE & LANDSCAPING AREA



PODIUM LOUNGE & LANDSCAPING AREA



All images used are for illustrative purposes only and do not represent the actual size, features, specifications, fittings and furnishings. The developer reserves the right to make revisions / alterations, at its absolute discretion, without any liability whatsoever.

PODIUM LOUNGE & LANDSCAPING AREA



POOL

