

INDIVIDUAL
FLOOR PLANS

3 BEDROOM DUPLEX APARTMENT

OPEN SPACE/PARK VIEW







TOTAL AREA: 238.92 SQM(2560.94 SQFT)

LOWER LEVEL



UPPER LEVEL



-  3 Bedrooms
-  Lounge
-  Kitchen
-  Jacuzzi
-  Balcony
-  Maid Room

UPPER LEVEL Park Facing



LOWER LEVEL Park Facing



2 BEDROOM APARTMENT
 MAIN ROAD + POOL VIEW
 TOTAL AREA: 133.47 SQM (1,436.68 SQFT)
 UNIT NO: 101



-  2 Bedrooms
-  Living
-  Kitchen
-  Swimming Pool
-  Terrace
-  Landscape







FIRST FLOOR



Pool View

2 BEDROOM APARTMENT
 MAIN ROAD + OPEN SPACE/PARK VIEW
 TOTAL AREA: 252.20 SQM (2,714.76 SQFT)
 UNIT NO: 102



-  2 Bedrooms
-  Living
-  Kitchen
-  Swimming Pool
-  Maid Room
-  Terrace
-  Landscape

FIRST FLOOR



Park View

Open Space

Main Road

1 BEDROOM APARTMENT

OPEN SPACE/PARK VIEW

TOTAL AREA:
103.96 SQM (1,119.45 SQFT)

UNIT NO: 103



ENTR.

TOTAL AREA:
103.96 SQM (1,119.02 SQFT)

UNIT NO: 104



ENTR.

-  1 Bedroom
-  Living
-  Kitchen
-  Swimming Pool
-  Study Room
-  Terrace



2 BEDROOM APARTMENT

OPEN SPACE/PARK VIEW (TWO SIDES)

TOTAL AREA: 253.13 SQM (2,724.67 SQFT)

UNIT NO: 105



ENTR.

-  2 Bedrooms
-  Living
-  Kitchen
-  Swimming Pool
-  Maid Room
-  Landscape
-  Terrace



2 BEDROOM APARTMENT
 OPEN SPACE/PARK + POOL VIEW
TOTAL AREA: 148.31 SQM (1,596.38 SQFT)
 UNIT NO: 106



-  2 Bedrooms
-  Living
-  Kitchen
-  Swimming Pool
-  Terrace
-  Landscape

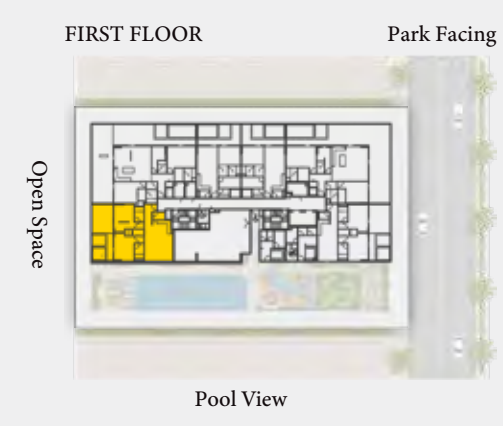

2 BEDROOM APARTMENT
 MAIN ROAD + OPEN SPACE/PARK VIEW/POOL VIEW



TOTAL AREA:
116.75 SQM (1,255.39 SQFT)
 UNIT NO: 201

TOTAL AREA:
118.75 SQ M (1,278.21 SQFT)
 UNIT NO: 202



-  2 Bedrooms
-  Living
-  Kitchen
-  Balcony + Pool

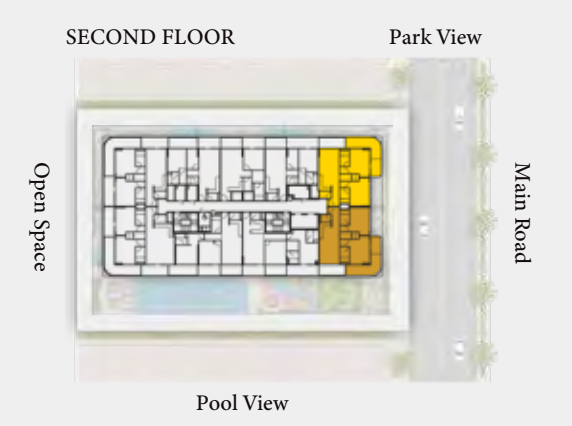

1 BEDROOM APARTMENT
 OPEN SPACE/PARK VIEW
TOTAL AREA: 85.45 SQM (919.78 SQFT)
 UNIT NO:203



-  1 Bedroom
-  Living
-  Kitchen
-  Balcony
-  Study Room



1 BEDROOM APARTMENT
 OPEN SPACE/PARK VIEW
TOTAL AREA: 78.03 SQM (839.91 SQFT)
 UNIT NO: 204



-  1 Bedroom
-  Living
-  Kitchen
-  Balcony

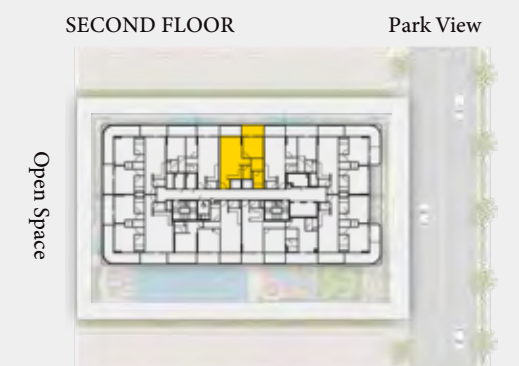

1 BEDROOM APARTMENT

OPEN SPACE/PARK VIEW

TOTAL AREA: 82.30 SQM (885.87 SQFT)

UNIT NO: 205



-  1 Bedroom
-  Study Room
-  Living
-  Kitchen
-  Balcony + Pool

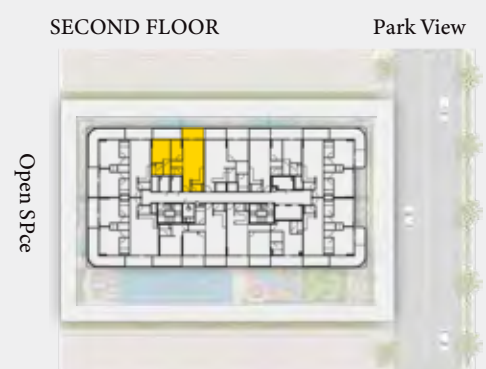

2 BEDROOM APARTMENT

POOL VIEW + OPEN SPACE /PARK VIEW

TOTAL AREA:
116.86 SQM (1,257.86 SQFT)

UNIT NO: 206



TOTAL AREA:
127.05 SQM (1,365.83 SQFT)

UNIT NO: 207

-  2 Bedrooms
-  Living
-  Kitchen
-  Balcony + Pool

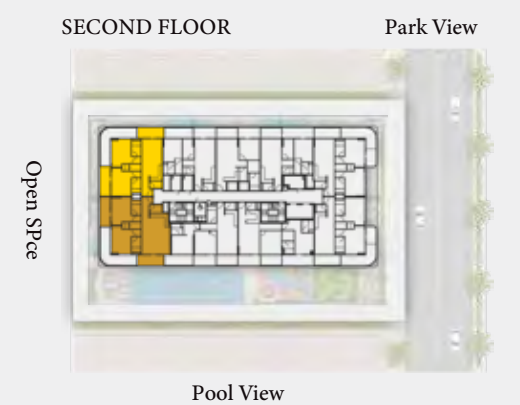

2 BEDROOM APARTMENT

NEIGHBOUR PLOT VIEW

TOTAL AREA: 98.52 SQM (1060.46 SQFT)

UNIT NO: 208



SECOND FLOOR



Neighbour Plot View

-  2 Bedrooms
-  Living
-  Kitchen
-  Balcony

2 BEDROOM APARTMENT

NEIGHBOUR PLOT VIEW

TOTAL AREA: 116.99 SQM (1,259.27 SQFT)

UNIT NO: 209



SECOND FLOOR



Neighbour Plot View

-  2 Bedrooms
-  Living
-  Kitchen
-  Balcony + Pool

2 BEDROOM APARTMENT

MAIN ROAD + OPEN SPACE/PARK VIEW/POOL VIEW

TOTAL AREA: 154.02 SQM (1,642.36 SQFT)

UNIT NO: 301/501



TOTAL AREA: 155.02 SQM (1,668.62 SQFT)

UNIT NO: 302/502



-  2 Bedrooms
-  Maid Room
-  Living
-  Kitchen
-  Balcony + Pool

THIRD & FIFTH FLOOR Park View



Pool View

1 BEDROOM APARTMENT

OPEN SPACE/PARK VIEW

TOTAL AREA: 80.36 SQM (864.99 SQFT)

UNIT NO: 303/503



-  1 Bedroom
-  Study Room
-  Living
-  Kitchen
-  Balcony + Pool

THIRD & FIFTH FLOOR Park Facing



Open Space

1 BEDROOM APARTMENT

OPEN SPACE/PARK VIEW

TOTAL AREA: 80.49 SQM (866.39 SQFT)

UNIT NO: 304/504



-  1 Bedroom
-  Study Room
-  Living
-  Kitchen
-  Balcony

THIRD & FIFTH FLOOR Park Facing



Open Space

2 BEDROOM APARTMENT

OPEN SPACE/PARK VIEW/POOL VIEW

TOTAL AREA: 170.15 SQM (1,831.48 SQFT)

UNIT NO: 305/505



TOTAL AREA: 166.47 SQM (1,790.47 SQFT)

UNIT NO: 306/506



-  2 Bedrooms
-  Main Room
-  Living
-  Kitchen
-  Balcony + Pool

THIRD & FIFTH FLOOR Park View



Open Space

Pool View



1 BEDROOM APARTMENT

POOL VIEW

TOTAL AREA: 74.14 SQM (797.05 SQFT)

UNIT NO:307/507



-  1 Bedroom
-  Living
-  Kitchen
-  Balcony + Pool
-  Store Room

THIRD & FIFTH FLOOR



Pool View

1 BEDROOM APARTMENT

NEIGHBOUR PLOT

TOTAL AREA: 68.5 SQM (737.76 SQFT)

UNIT NO:308/508



-  1 Bedroom
-  Living
-  Kitchen
-  Balcony

THIRD & FIFTH FLOOR



Neighbour Plot

2 BEDROOM APARTMENT

MAIN ROAD + OPEN SPACE/PARK VIEW/POOL VIEW

TOTAL AREA: 166.17 SQM (1,786.38 SQFT)

UNIT NO: 401/601



TOTAL AREA: 168.5 SQM (1,812.43 SQFT)

UNIT NO: 402/602



-  2 Bedroom
-  Maid Room
-  Living
-  Kitchen
-  Balcony + Pool

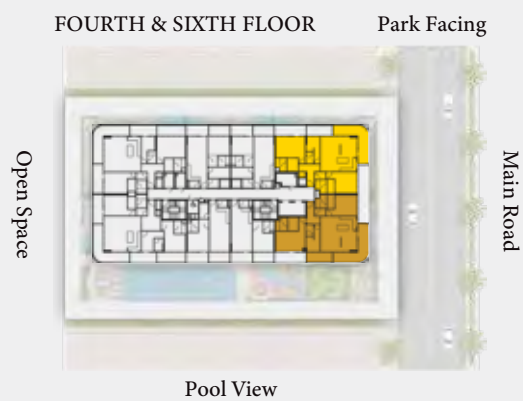

1 BEDROOM APARTMENT

OPEN SPACE/PARK VIEW

TOTAL AREA: 80.5 SQM (865.85 SQFT)

UNIT NO: 403/603



-  1 Bedrooms
-  Study Room
-  Living
-  Kitchen
-  Balcony



1 BEDROOM APARTMENT

OPEN SPACE/PARK VIEW

TOTAL AREA: 252.21 SQM (867.25 SQFT)

UNIT NO: 404/604



-  1 Bedrooms
-  Study Room
-  Living
-  Kitchen
-  Balcony + Pool

FOURTH & SIXTH FLOOR Park View



Open Space

2 BEDROOM APARTMENT

OPEN SPACE/PARK VIEW/POOL VIEW

TOTAL AREA: 156.3 SQM (1,680.35 SQFT)

UNIT NO: 405/605



TOTAL AREA: 152.46 SQM (1,639.02 SQFT)

UNIT NO: 406/606



-  2 Bedroom
-  Maid Room
-  Living
-  Kitchen
-  Balcony + Pool

FOURTH & SIXTH FLOOR Park View



Open Space

Pool View

1 BEDROOM APARTMENT

OPEN GREEN AREA

TOTAL AREA: 74.20 SQM (797.97 SQFT)

UNIT NO: 407/607



-  1 Bedrooms
-  Living
-  Kitchen
-  Store Room

FOURTH & SIXTH FLOOR



Open Green Area

1 BEDROOM APARTMENT

OPEN GREEN AREA

TOTAL AREA: 68.7 SQM (738.62 SQFT)

UNIT NO: 408/608



-  2 Bedroom
-  Living
-  Kitchen
-  Balcony + Pool

FOURTH & SIXTH FLOOR



Open Green Area