

# SPARKLZ

BY **DANUBE**

FLOOR PLANS





# FLEX STUDIO-A

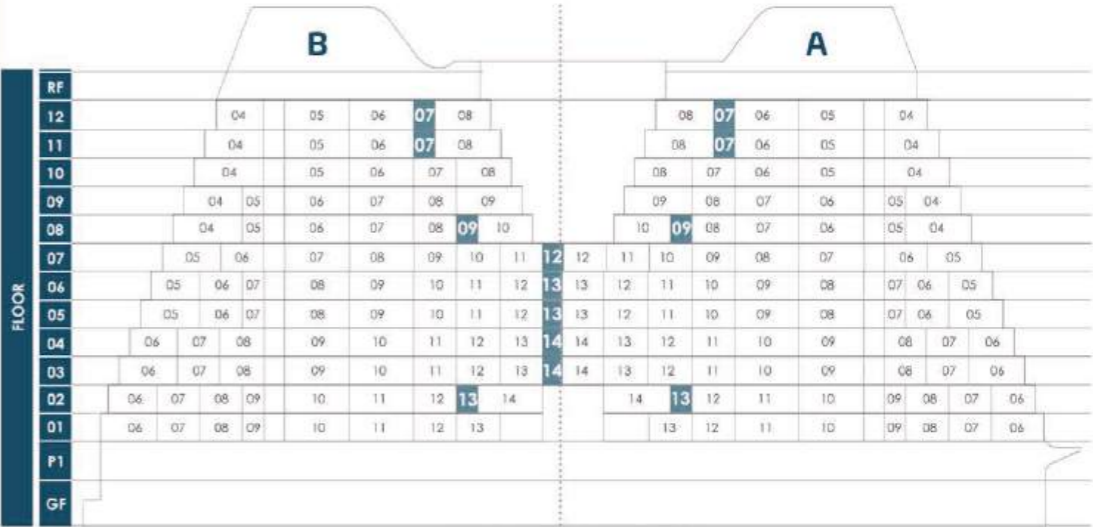
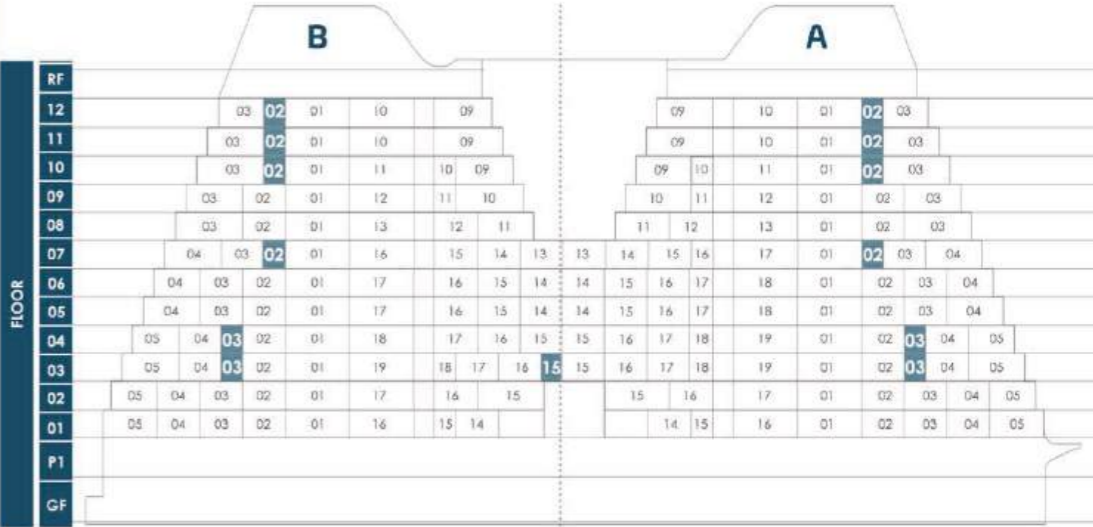

## AREA (Sq.Ft)

Apartment  
**348 to 350**

Balcony  
**60 to 61**

Total  
**408 to 410**

**FEATURES:**

☒ **Convertible 1BHK**



## FLEX STUDIO-B

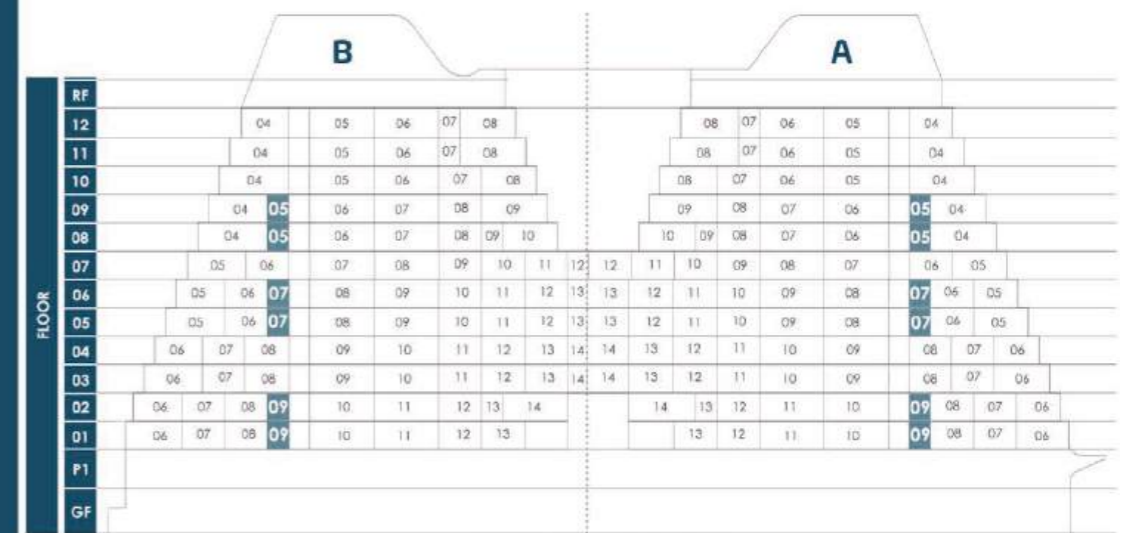
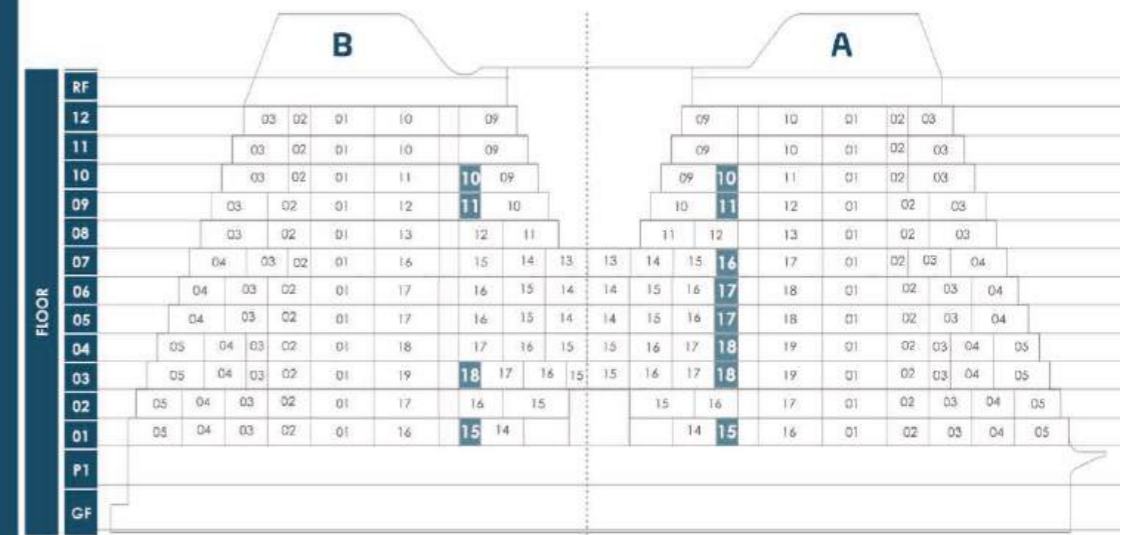

### AREA (Sq.Ft)

Apartment  
**354**

Balcony  
**130 to 132**

Total  
**484 to 486**

### FEATURES:

☒ **Convertible 1BHK**



# FLEX 1 BEDROOM-A

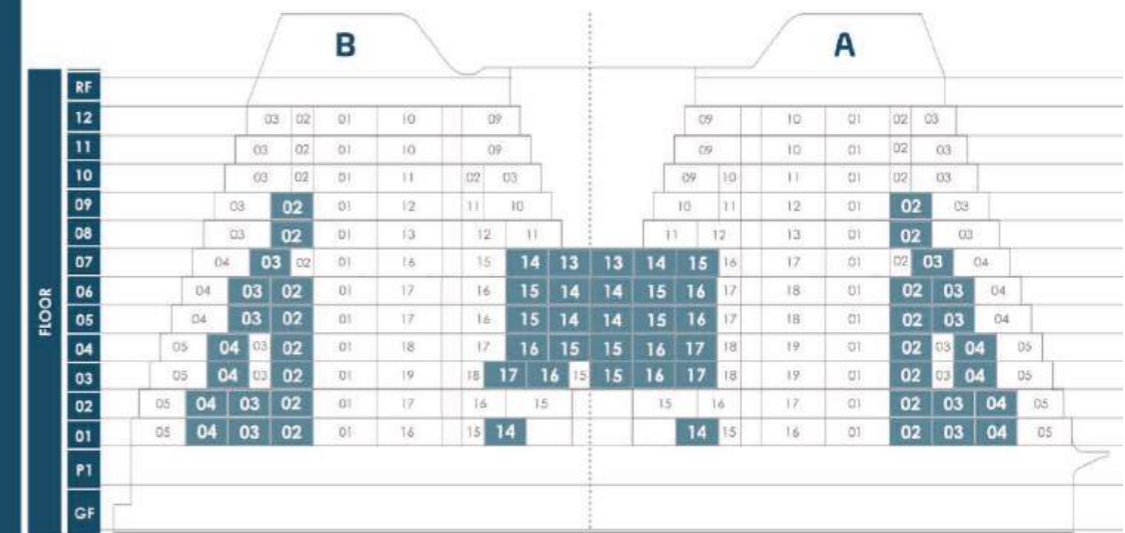

CITY SKYLINE VIEW

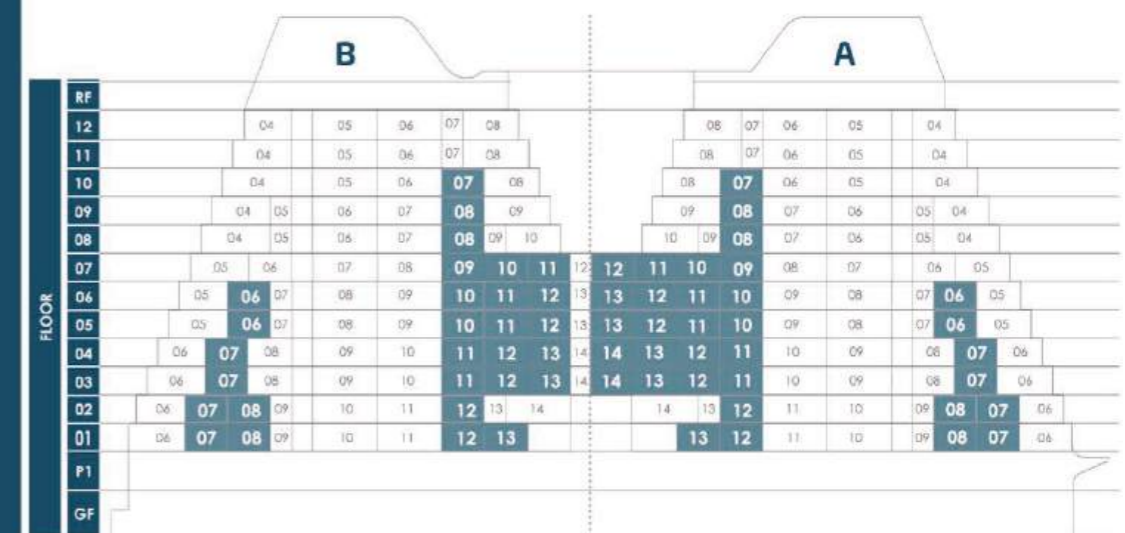

GARDENS VIEW

## AREA (Sq.Ft)

Apartment  
**696 to 708**

Balcony  
**120 to 122**

Total  
**816 to 829**

## FEATURES:

- ☒ Convertible 2BHK
- ☒ Maid Room (w) Bath
- ☒ Office



# FLEX 1 BEDROOM-B

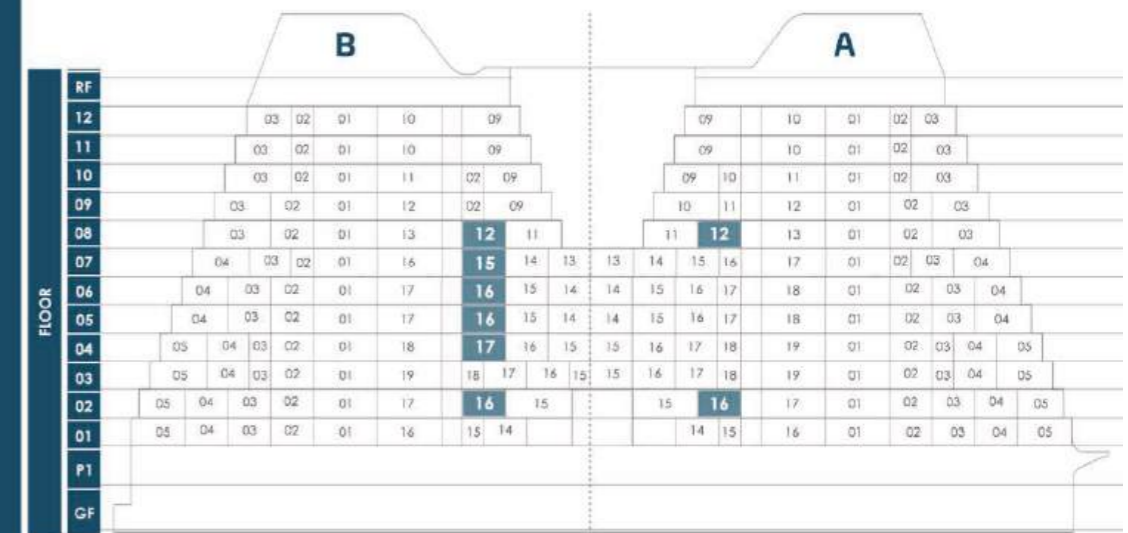

CITY SKYLINE VIEW

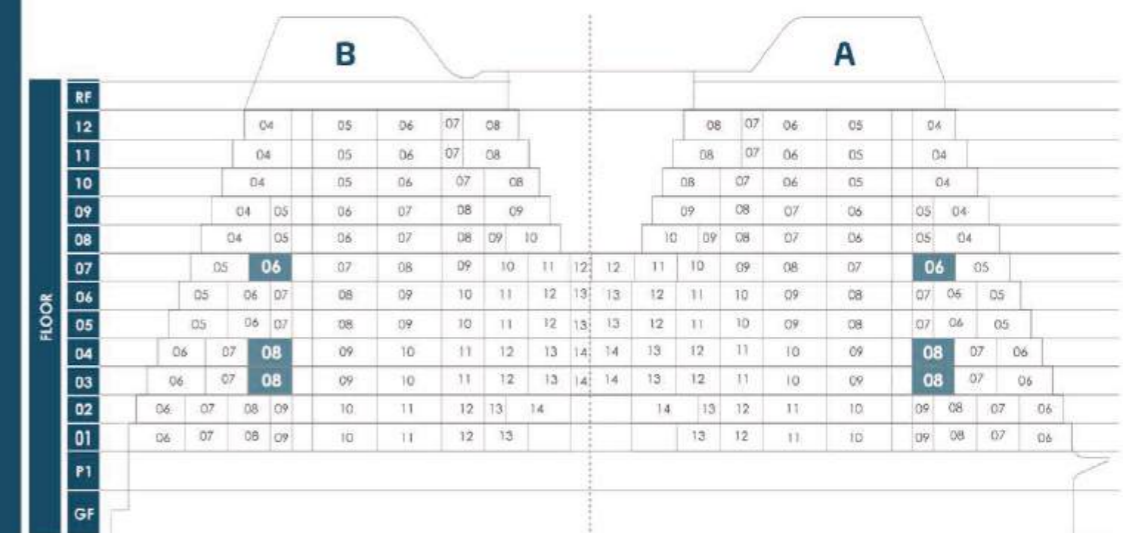

GARDENS VIEW

## AREA (Sq.Ft)

Apartment  
**701 to 703**

Balcony  
**191**

Total  
**892 to 894**

## FEATURES:

- ☒ Convertible 2BHK
- ☒ Maid Room (w) Bath
- ☒ Office



## 2 BEDROOM-A

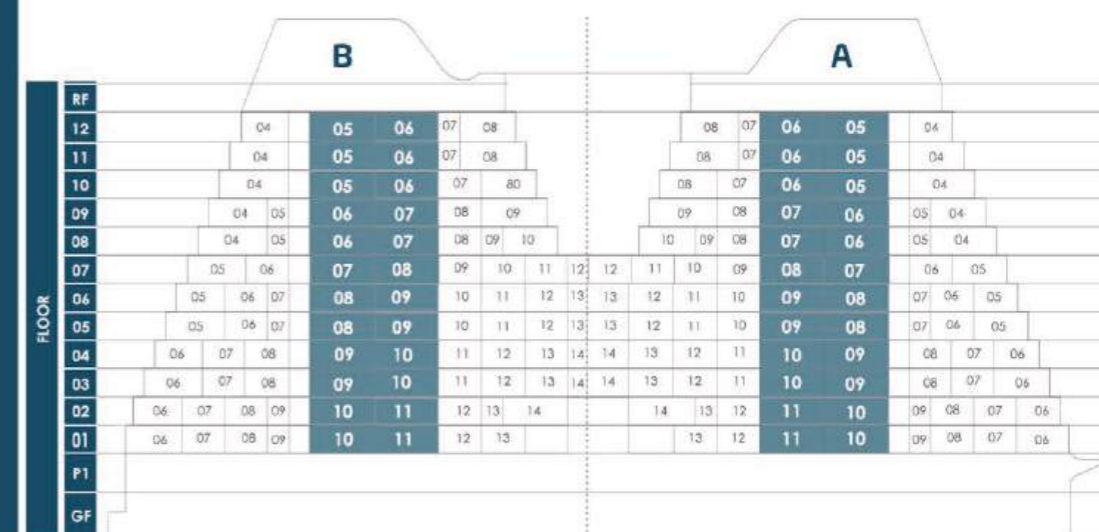
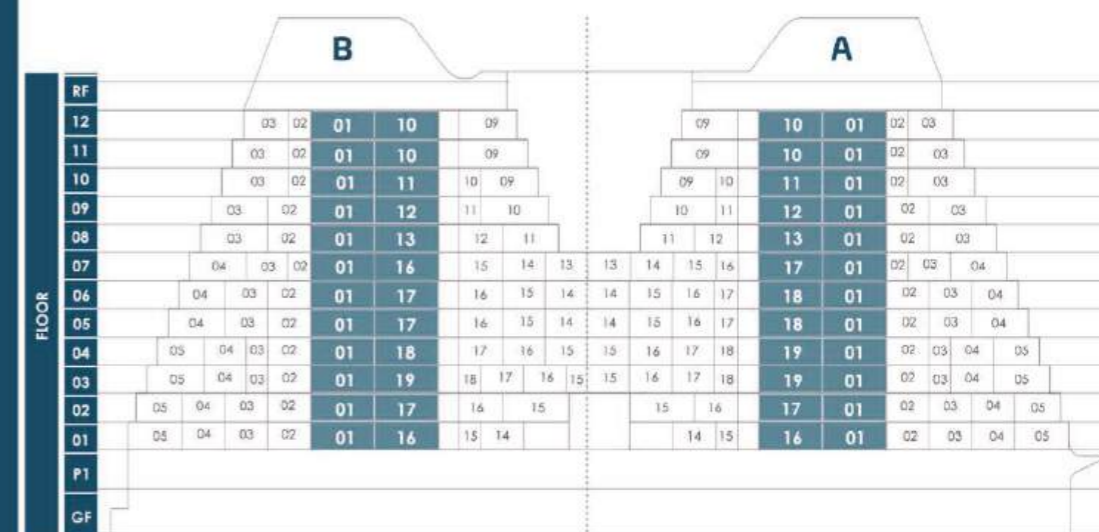

### AREA (Sq.Ft)

Apartment  
**891 to 908**

Balcony  
**180 to 183**

Total  
**1,072 to 1,091**

### FEATURES:

☒ **Maid Room**



## 2 BEDROOM-B

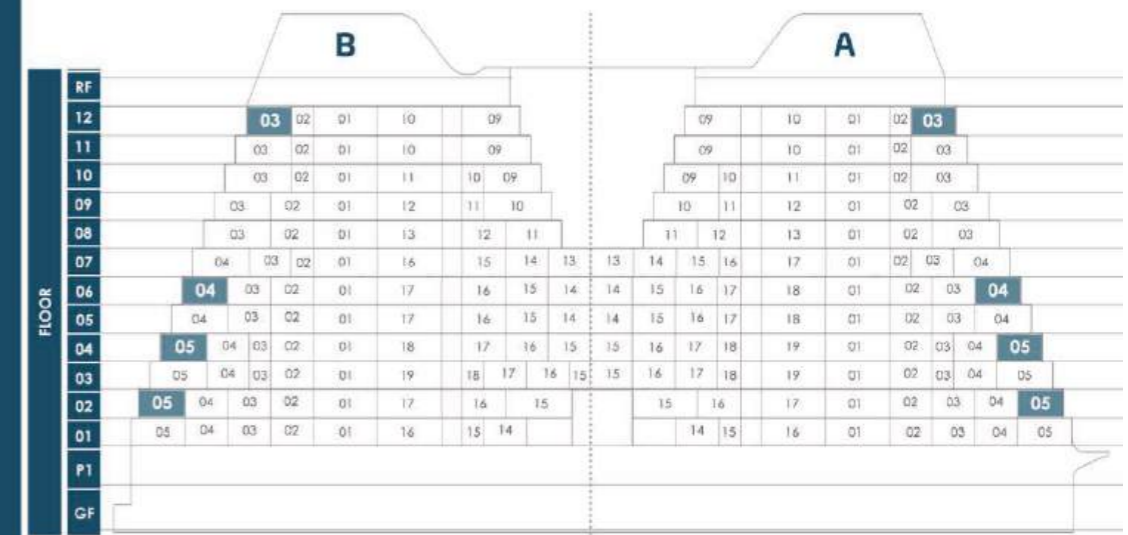

CITY SKYLINE VIEW

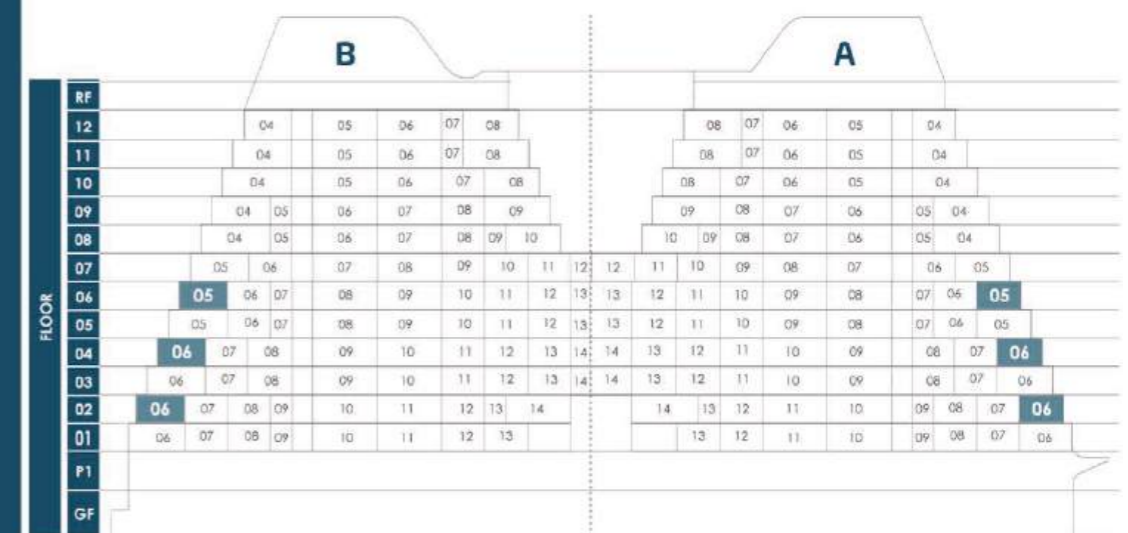

GARDENS VIEW

### AREA (Sq.Ft)

Apartment  
**794 to 801**

Balcony  
**339 to 345**

Total  
**1,137 to 1,144**



## 3 BEDROOM-A

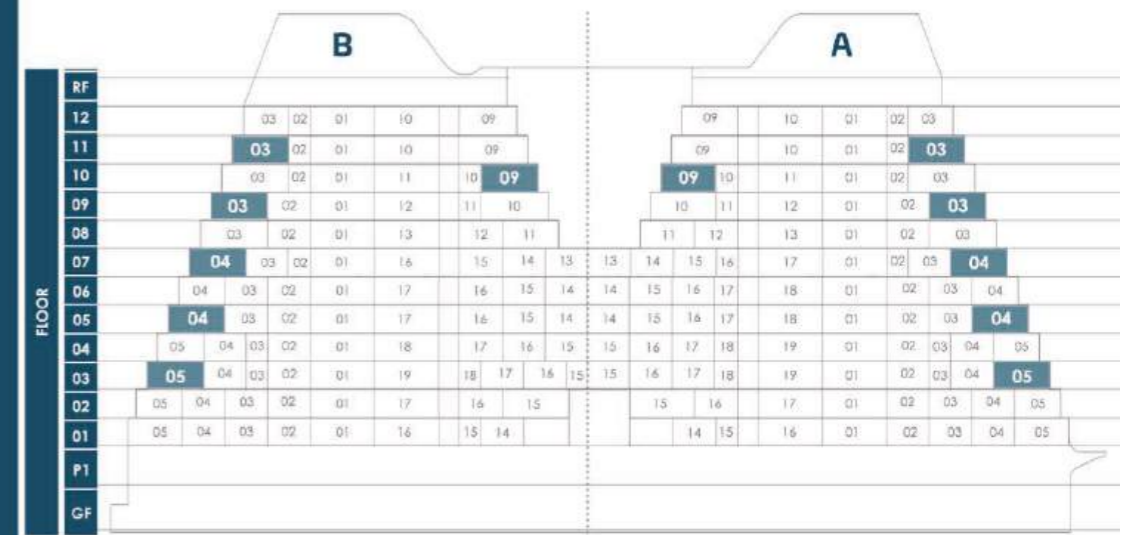

CITY SKYLINE VIEW

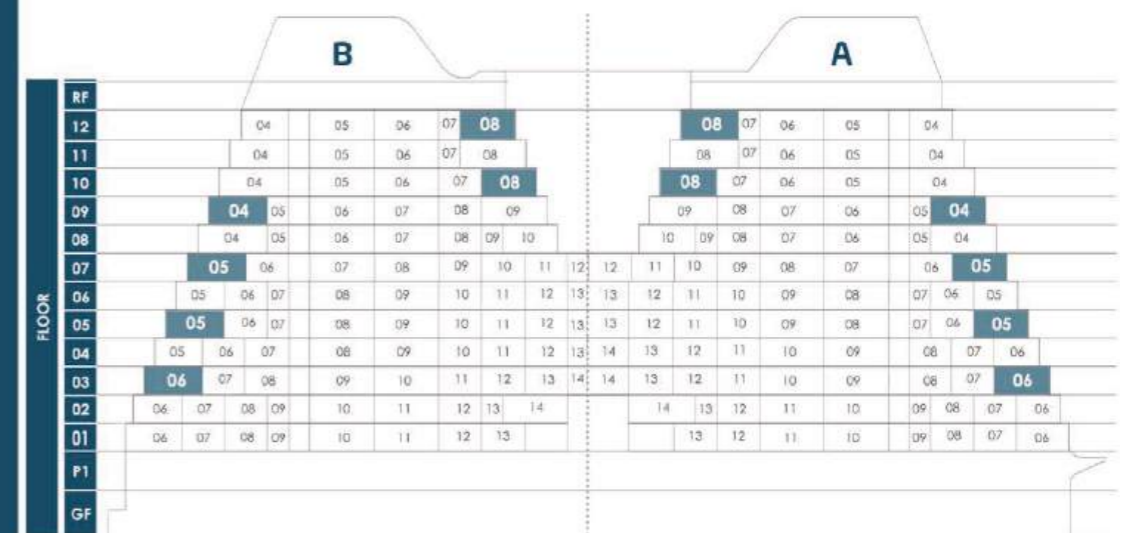

GARDENS VIEW

### AREA (Sq.Ft)

Apartment  
**1,013 to 1,016**

Balcony  
**365**

Total  
**1,378 to 1,381**

# 3 BEDROOM-B

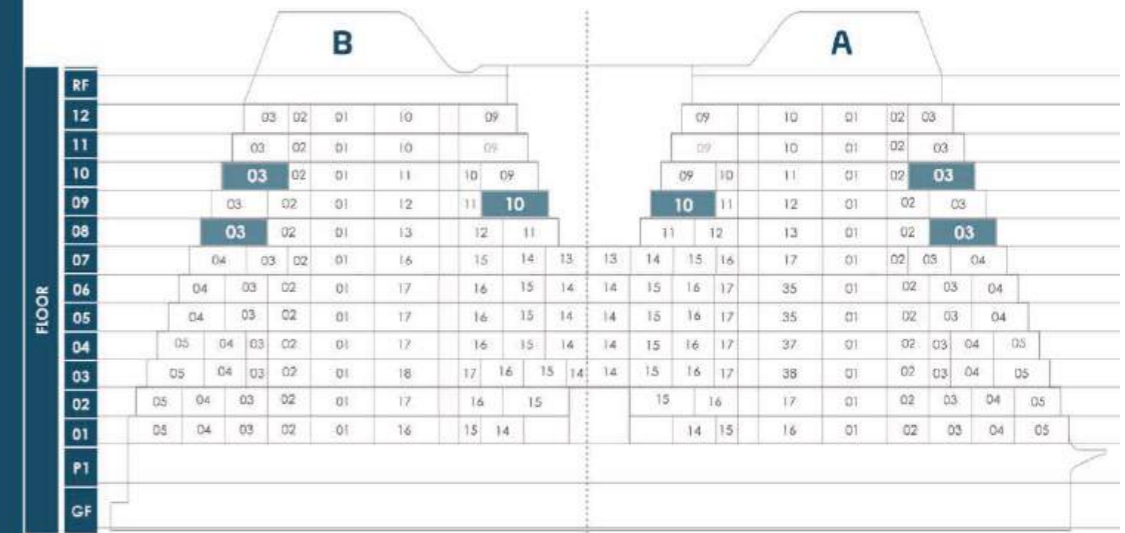

CITY SKYLINE VIEW

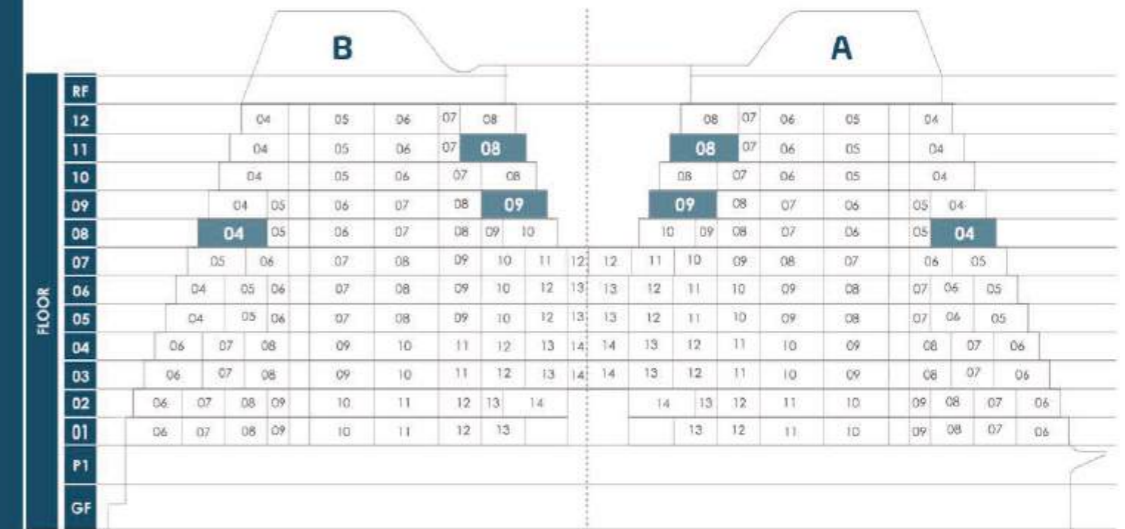

GARDENS VIEW

## AREA (Sq.Ft)

Apartment  
**1,221 to 1,224**

Balcony  
**381 to 383**

Total  
**1,603 to 1,606**

## FEATURES:

- ☒ Maid Room
- ☒ Store

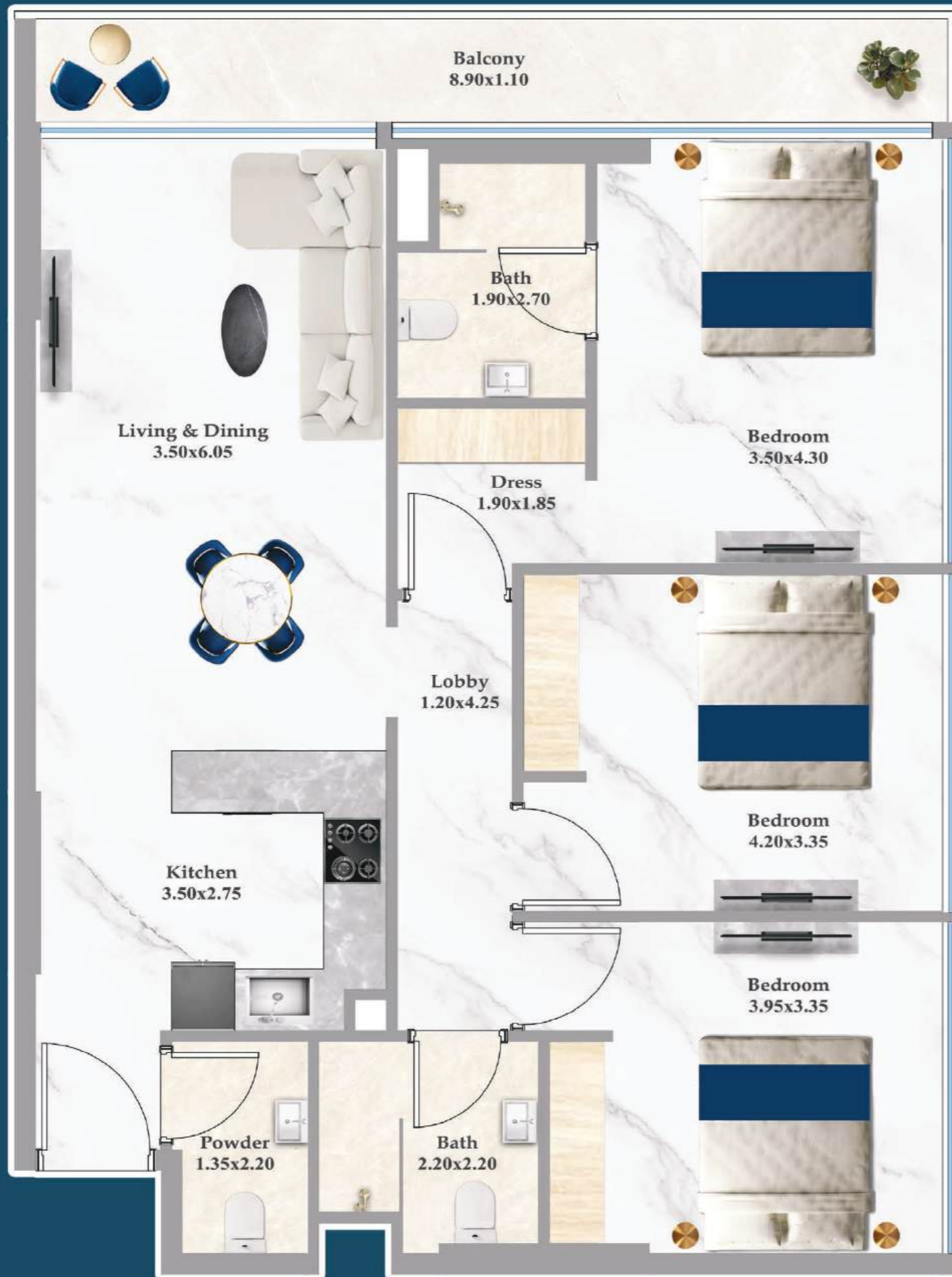

## 3 BEDROOM-C

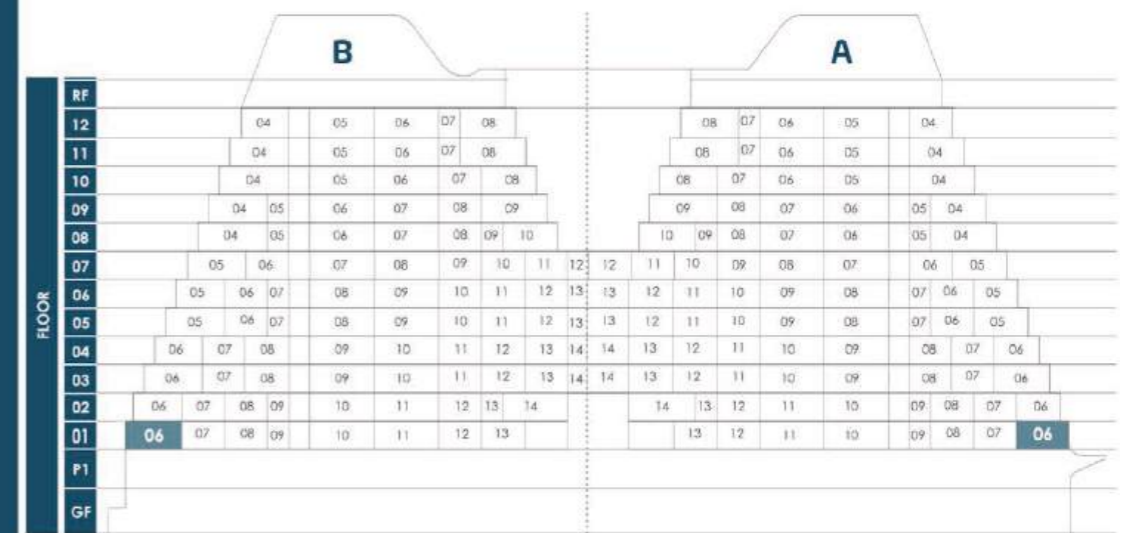
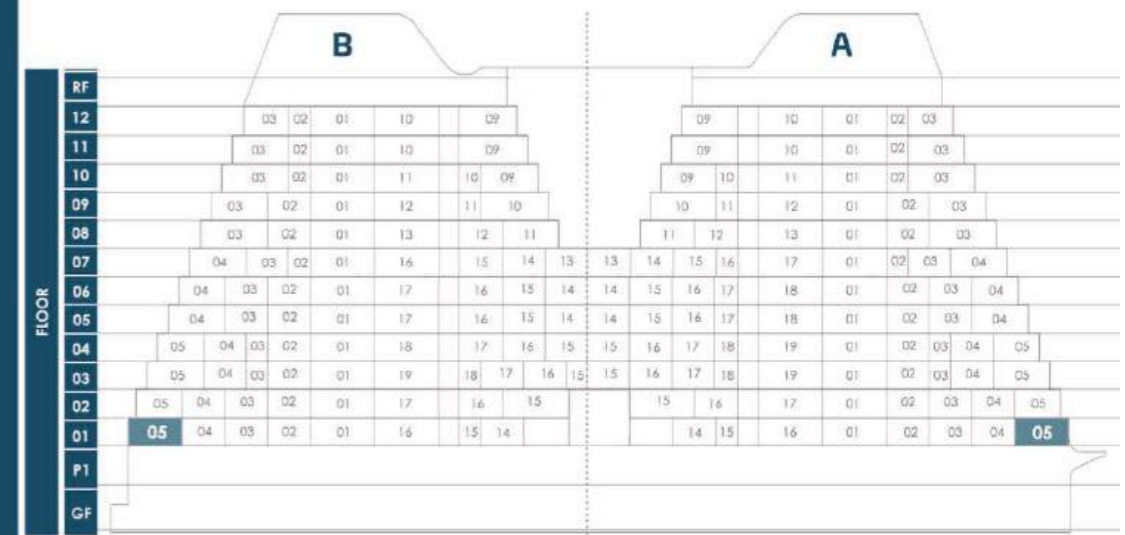

### AREA (Sq.Ft)

Apartment  
**1,012 to 1,013**

Balcony  
**112**

Total  
**1,124 to 1,125**

# 3 BEDROOM-D

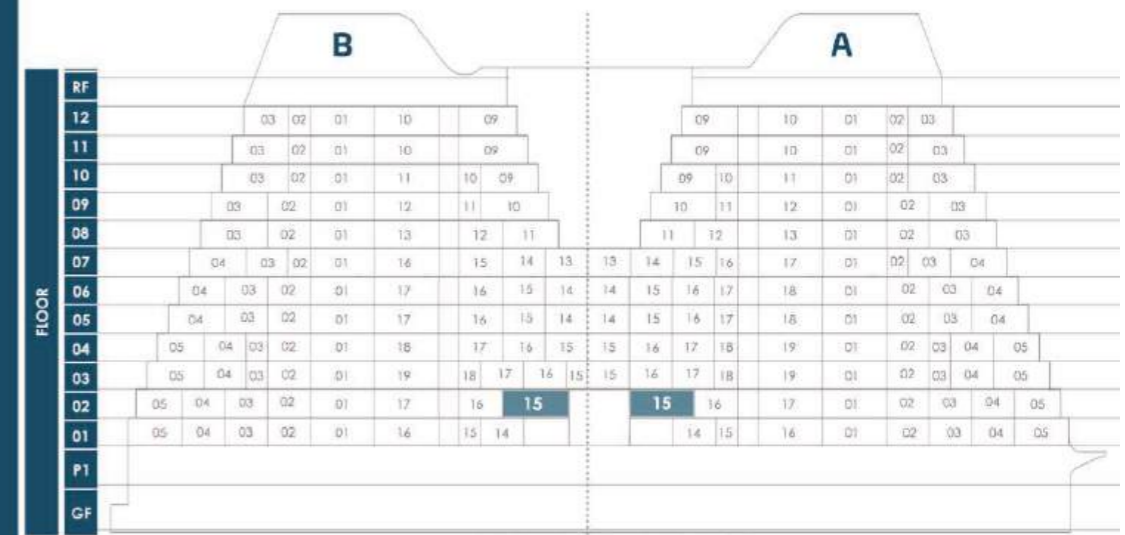

CITY SKYLINE VIEW

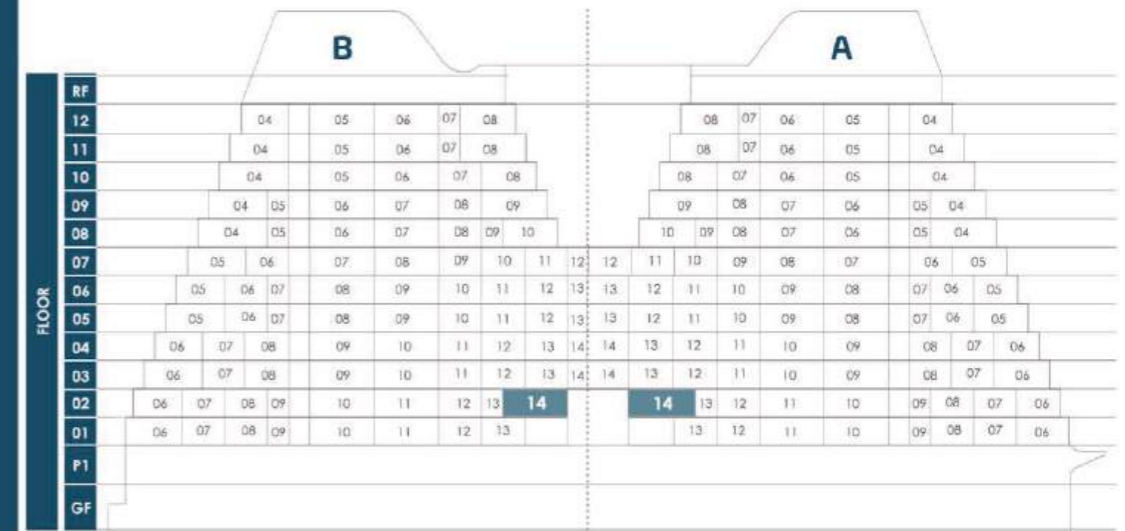

GARDENS VIEW

## AREA (Sq.Ft)

Apartment

**1,225**

Balcony

**122**

Total

**1,347**

## FEATURES:

☒ Maid Room (w) Bath

☒ Store

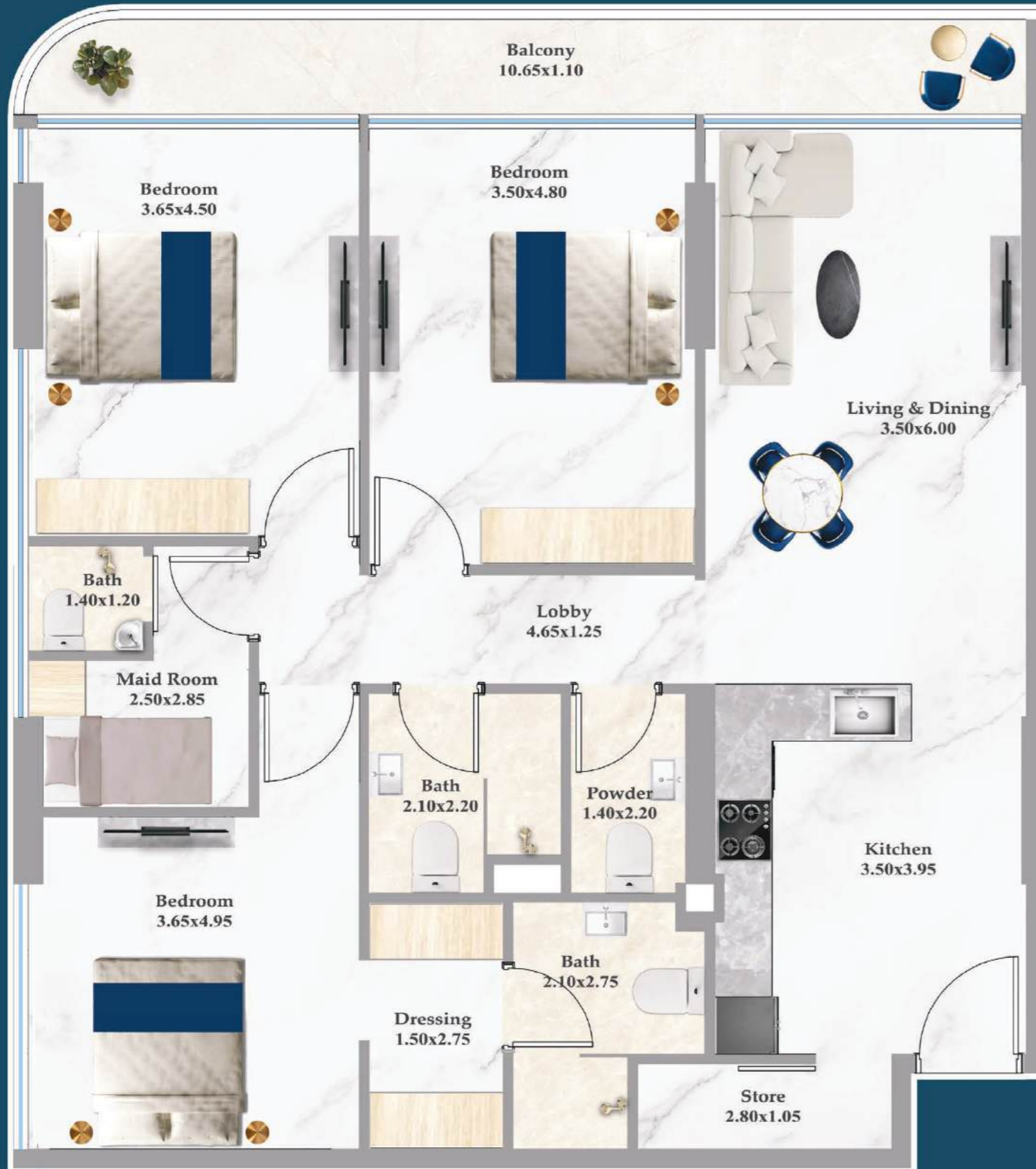



CITY SKYLINE VIEW

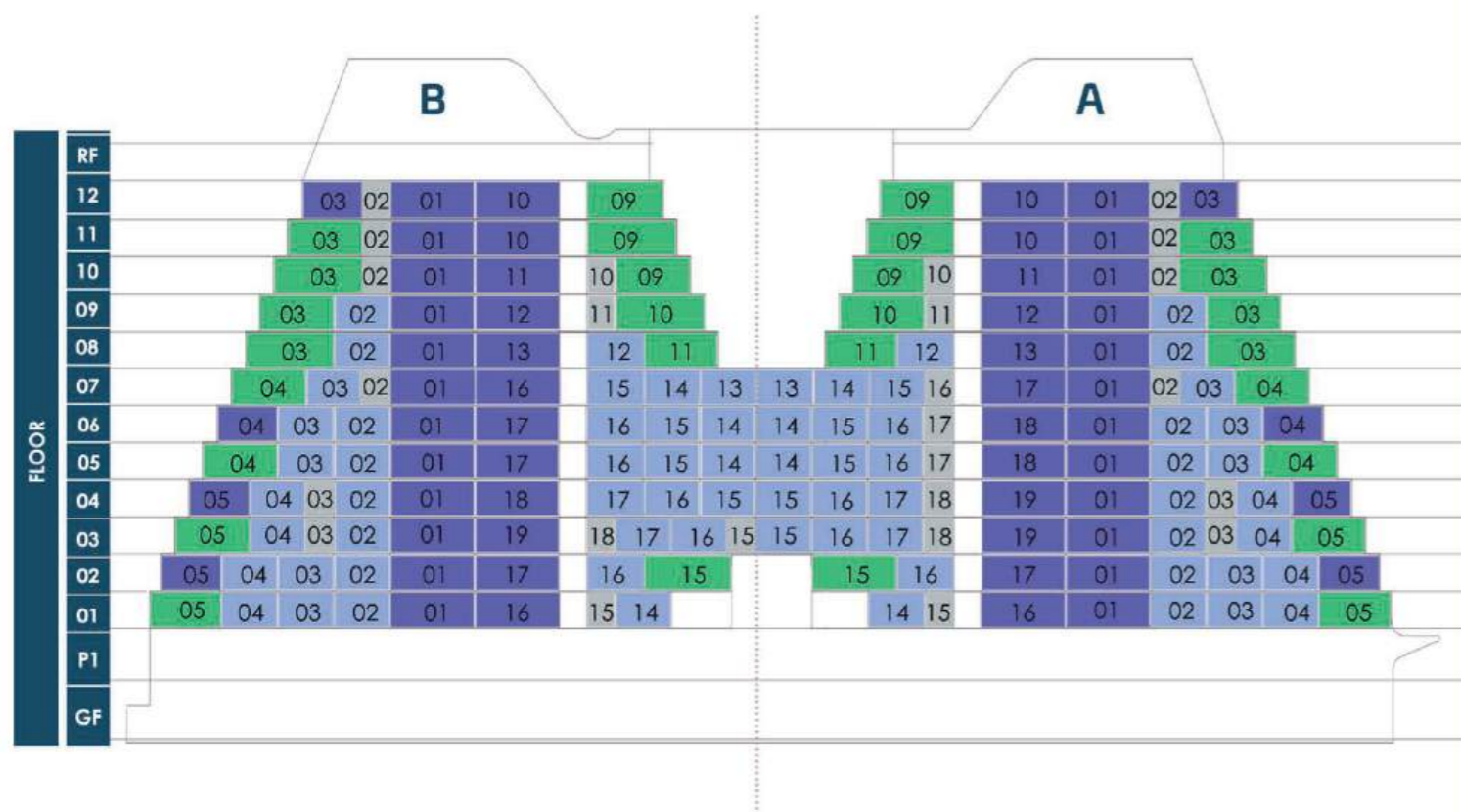

GARDENS VIEW

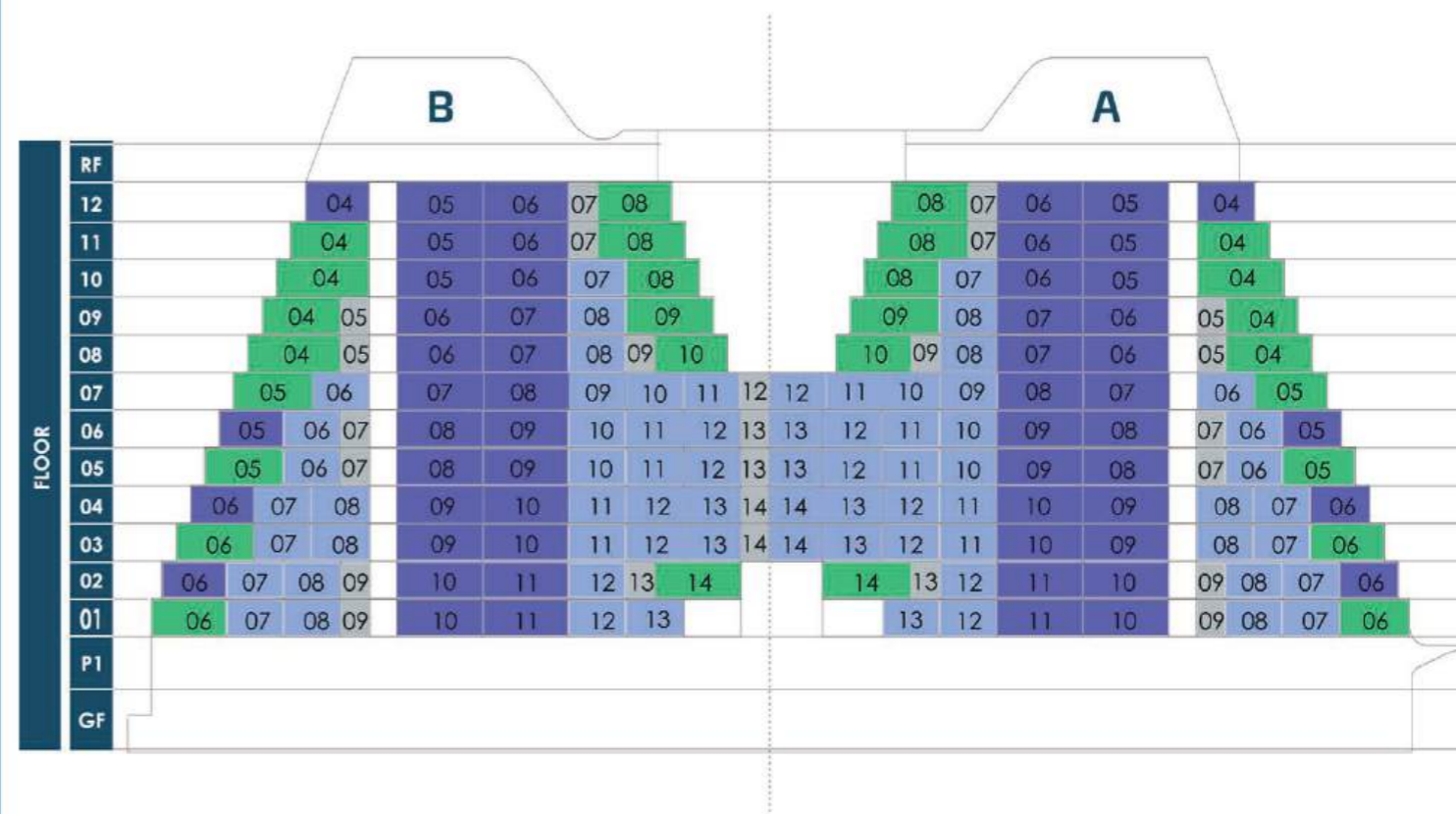

- STUDIO
- 1 BEDROOM
- 2 BEDROOMS
- 3 BEDROOMS

GARDENS VIEW

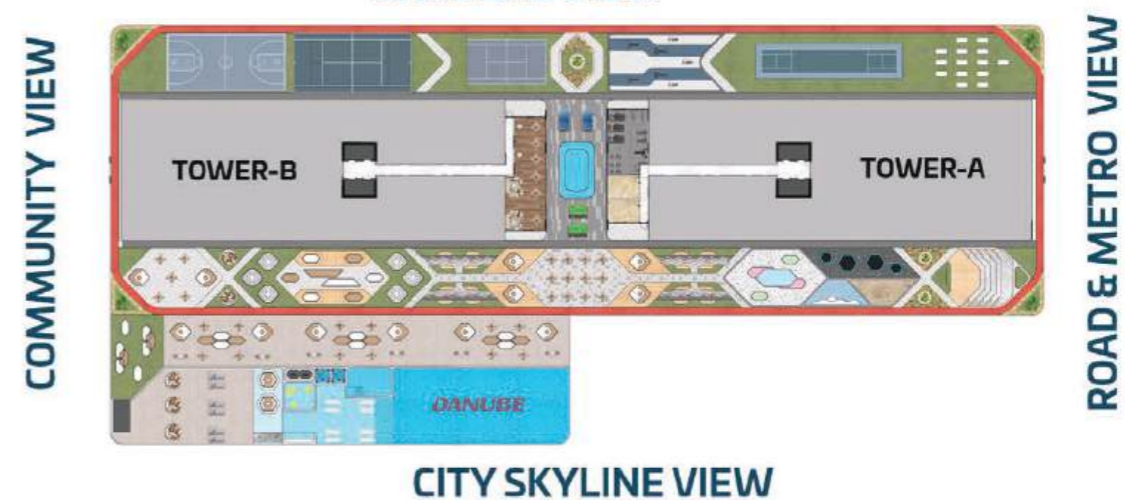



## SPARKLZ AMENITIES

- |                             |                            |                     |
|-----------------------------|----------------------------|---------------------|
| 5. Infinity Pool            | 20. Zumba Dance            | 35. Badminton Court |
| 6. Shallow Pool             | 21. Sparklz Photo Booth    | 36. Paddle Court    |
| 7. Jacuzzi                  | 22. Open Air Cinema        | 37. Basketball      |
| 8. Foot Bath                | 23. Outdoor Party Area     | 38. Mini Golf       |
| 9. Aquatic Gym              | 24. Indoor Party Area      | 39. Changing Room   |
| 10. Kids Pool               | 25. Spa & Therapy          |                     |
| 11. Splash Pad              | 26. Kids Daycare           |                     |
| 12. Floating Cabana         | 27. Kids Play Area         |                     |
| 13. Pool Deck               | 28. Joggers' Arena         |                     |
| 14. Pool Party Zone         | 29. Yoga Zone              |                     |
| 15. Sparklz Garden          | 30. Cricket Pitch          |                     |
| 16. Cabana & Family Seating | 31. Football Court         |                     |
| 17. BBQ Zone                | 32. Outdoor Gym            |                     |
| 18. Health Bar              | 33. Indoor Gym             |                     |
| 19. Reflexology Path        | 34. Snooker & Table Tennis |                     |



N

## FLOOR 1 AMENITIES

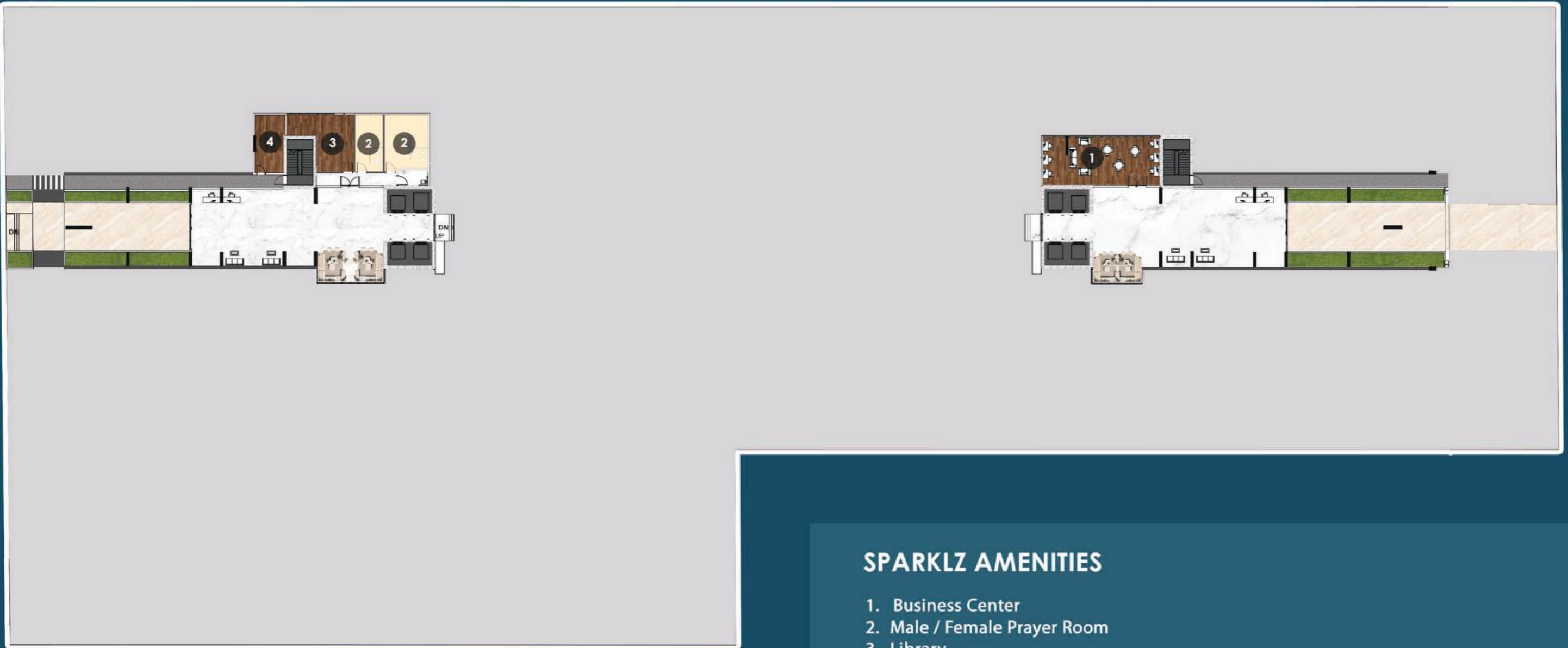

## SPARKLZ AMENITIES

1. Business Center
2. Male / Female Prayer Room
3. Library
4. Beauty Salon



## GROUND FLOOR AMENITIES



1. All Information, materials, plans and amenities are approximate and provided for illustrative purposes only. The Developer reserves the right to make revisions to the floor plans and any features, materials, dimensions, drawings, and amenities of the project without notice.  
2. Units areas, actual dimensions, layout, location, specifications of balcony, door, wardrobe or other fixtures may vary floor to floor and between units and are subject to revision by the Developer.  
3. Furniture and electric devices will not be provided by the Developer, unless specified otherwise in the Unit Sale Purchase Agreement.  
4. The circulation area dimensions may be added to the nearby rooms & or the spaces dimensions for illustration purpose.

**DANUBE**  
**PROPERTIES**



Dubai | Abu Dhabi | Muscat | Riyadh | Bahrain | London | China  
Mumbai | New Delhi | Gurugram | Kochi | Hyderabad

+971 800 57 57

danubeproperties.com

info@danubeproperties.ae