

E L A R I S

Axis

Object 1

Dubai Is a Gallery,
and Buildings Are Showpieces

Floor Plans

GROUND FLOOR
FLOOR: G

ELARIS
Archi

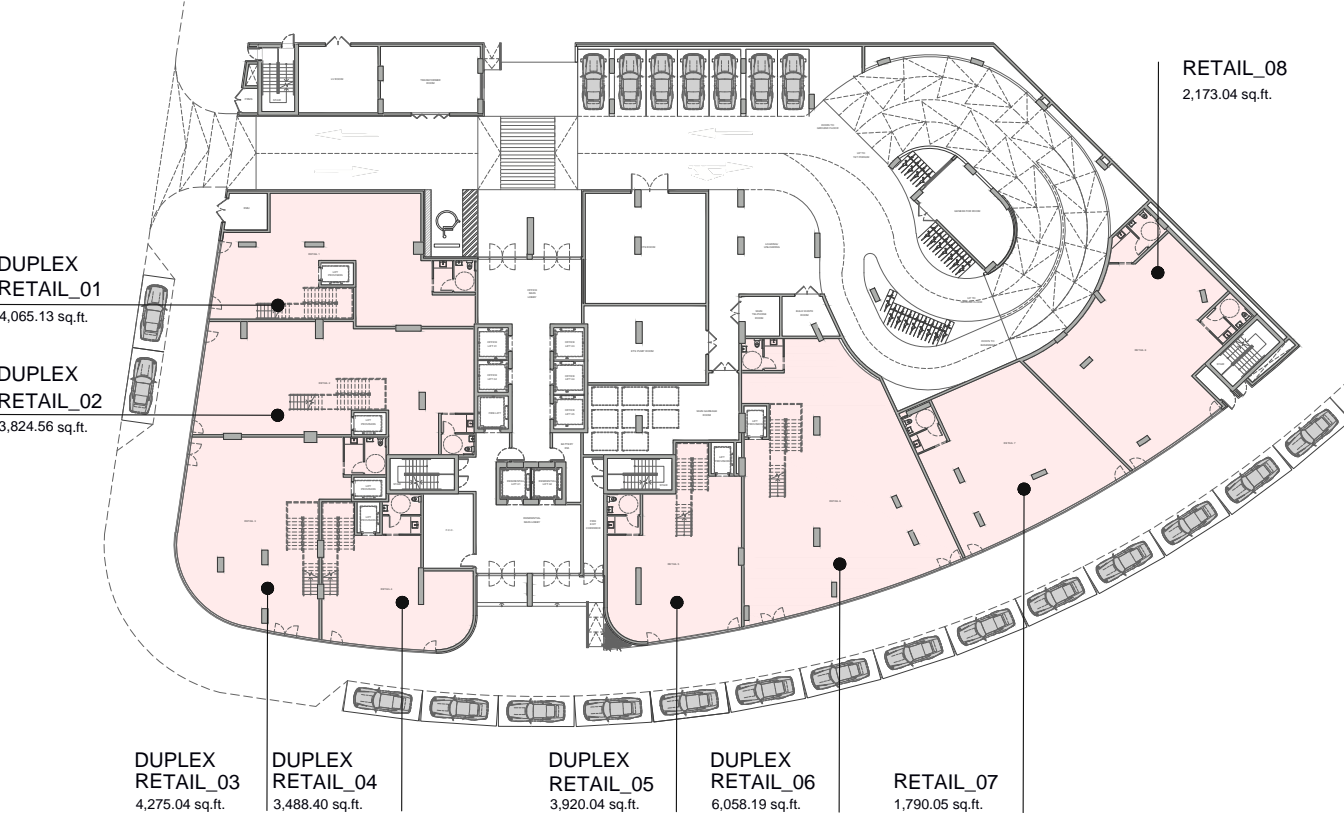

Disclaimer: all pictures, plans, layouts, information, data and details included in this brochure are indicative only may change at any time up to the final "as built" status in accordance with the final designs of the project, regulatory approvals and planning permissions

TYPICAL FLOOR
FLOOR: PODIUM 1

ELARIS
Arch

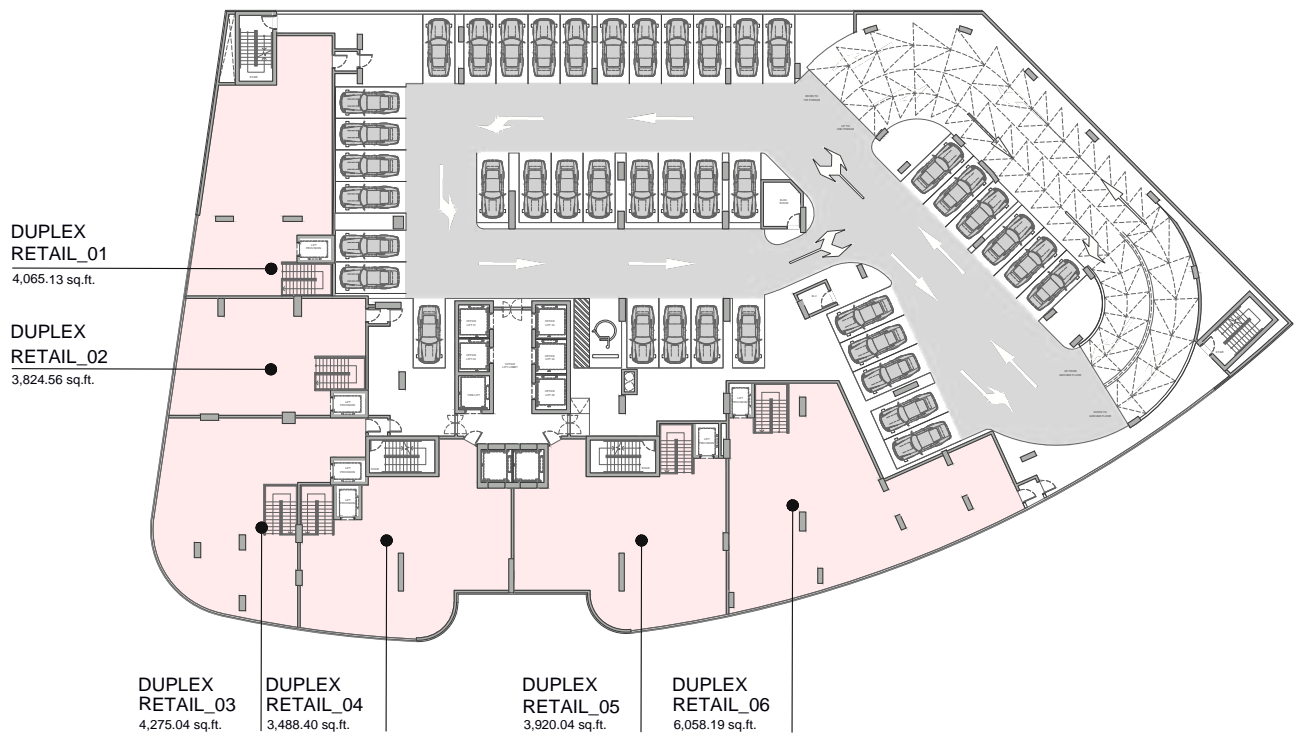

TYPICAL FLOOR
FLOOR: 1

ELARIS
Aras

DUBAI MARINA, JUMEIRAH ISLANDS



SHEIKH MOHAMMED BIN ZAYED RD (E 311)

Disclaimer: all pictures, plans, layouts, information, data and details included in this brochure are indicative only may change at any time up to the final "as built" status in accordance with the final designs of the project, regulatory approvals and planning permissions

TYPICAL FLOOR
FLOOR: 2

ELARIS
Apex

DUBAI MARINA, JUMEIRAH ISLANDS

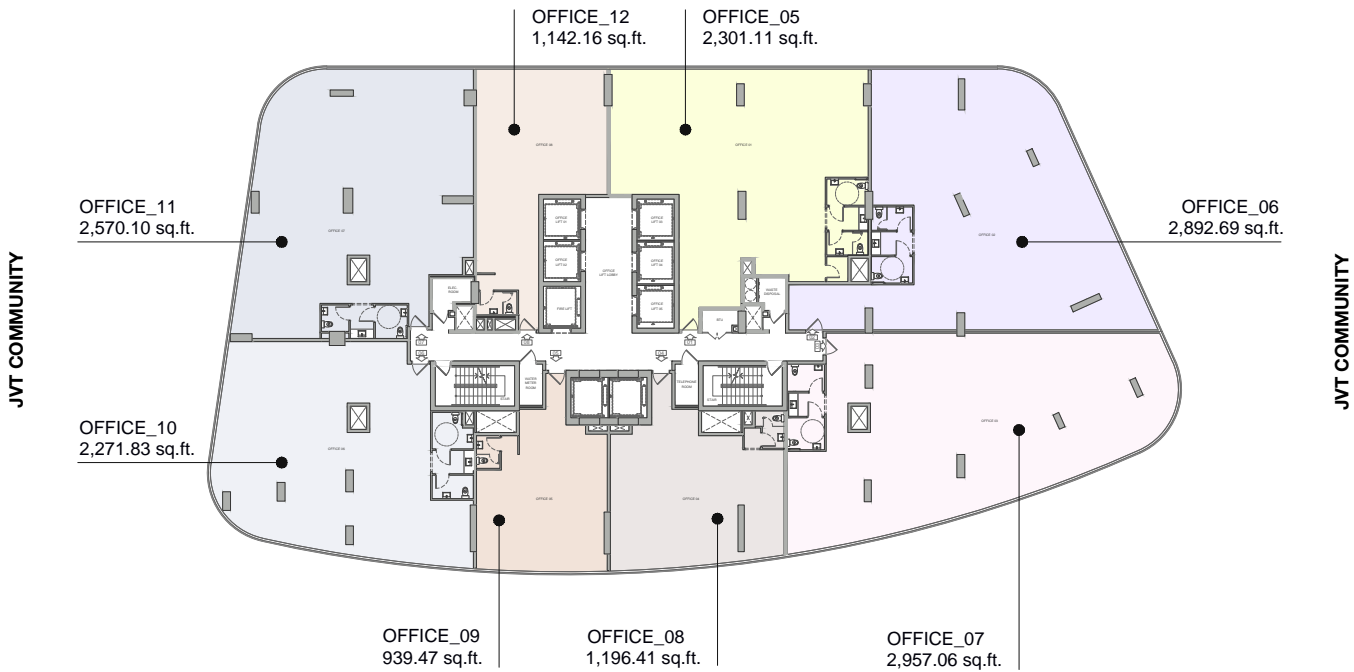

SHEIKH MOHAMMED BIN ZAYED RD (E 311)

Disclaimer: all pictures, plans, layouts, information, data and details included in this brochure are indicative only may change at any time up to the final "as built" status in accordance with the final designs of the project, regulatory approvals and planning permissions

TYPICAL FLOOR
FLOOR: 3

ELARIS
Apex

DUBAI MARINA, JUMEIRAH ISLANDS

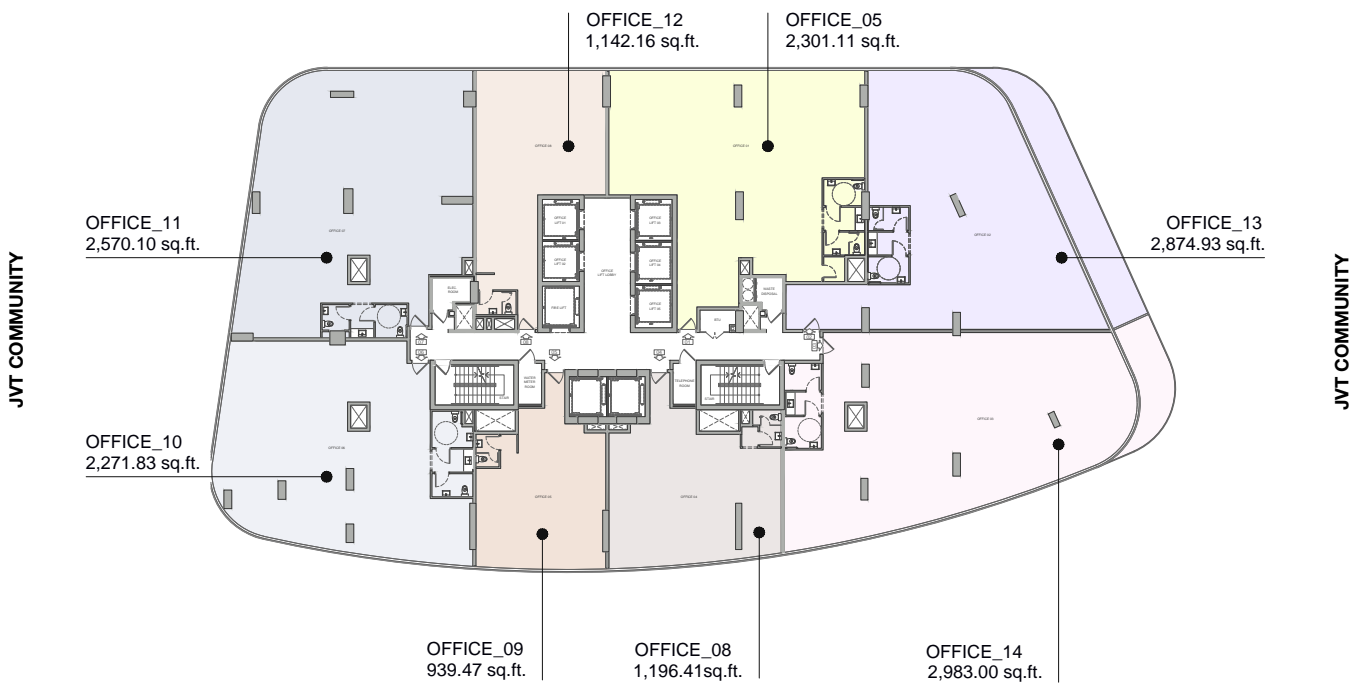

SHEIKH MOHAMMED BIN ZAYED RD (E 311)

Disclaimer: all pictures, plans, layouts, information, data and details included in this brochure are indicative only may change at any time up to the final "as built" status in accordance with the final designs of the project, regulatory approvals and planning permissions

TYPICAL FLOOR
FLOOR: 4

ELARIS
Apex

DUBAI MARINA, JUMEIRAH ISLANDS

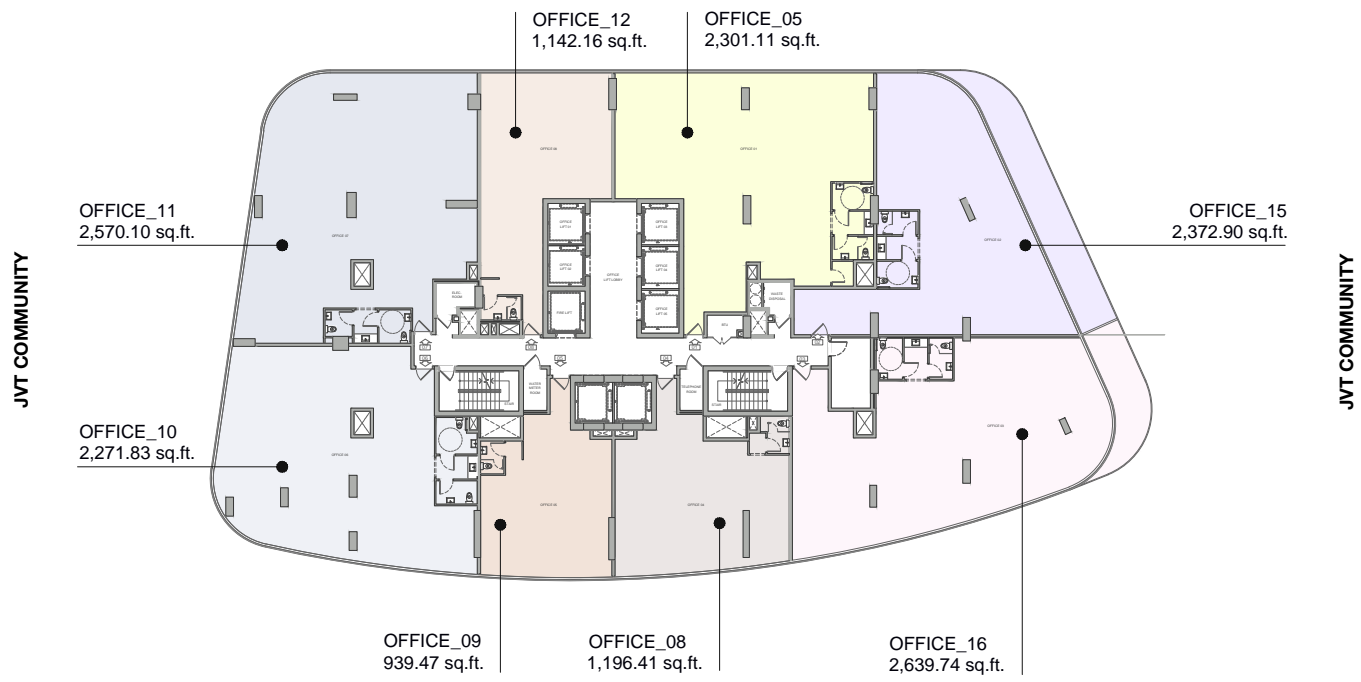

SHEIKH MOHAMMED BIN ZAYED RD (E 311)

Disclaimer: all pictures, plans, layouts, information, data and details included in this brochure are indicative only may change at any time up to the final "as built" status in accordance with the final designs of the project, regulatory approvals and planning permissions

TYPICAL FLOOR
FLOOR: 5

ELARIS
Apex

DUBAI MARINA, JUMEIRAH ISLANDS

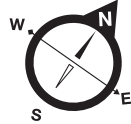
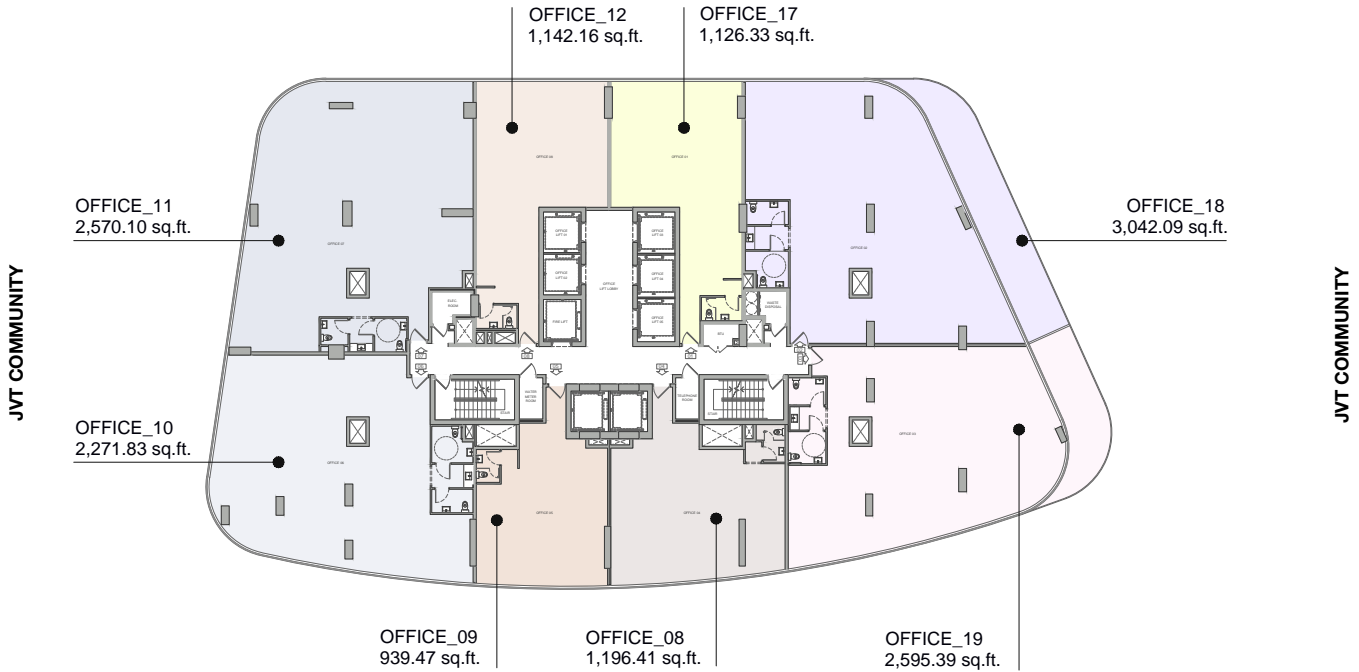

SHEIKH MOHAMMED BIN ZAYED RD (E 311)

Disclaimer: all pictures, plans, layouts, information, data and details included in this brochure are indicative only may change at any time up to the final "as built" status in accordance with the final designs of the project, regulatory approvals and planning permissions

TYPICAL FLOOR
FLOOR: 6

ELARIS
Aras

DUBAI MARINA, JUMEIRAH ISLANDS

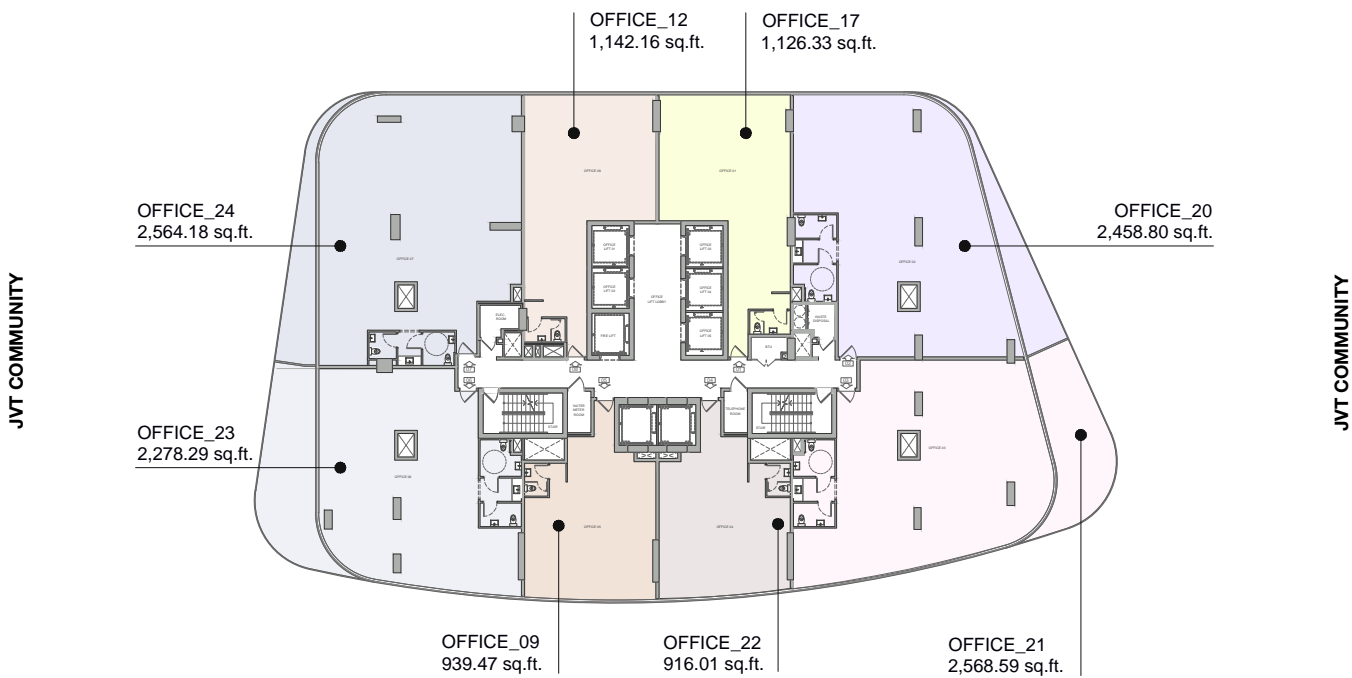

SHEIKH MOHAMMED BIN ZAYED RD (E 311)

Disclaimer: all pictures, plans, layouts, information, data and details included in this brochure are indicative only may change at any time up to the final "as built" status in accordance with the final designs of the project, regulatory approvals and planning permissions

TYPICAL FLOOR
FLOOR: 7

ELARIS
Apex

DUBAI MARINA, JUMEIRAH ISLANDS

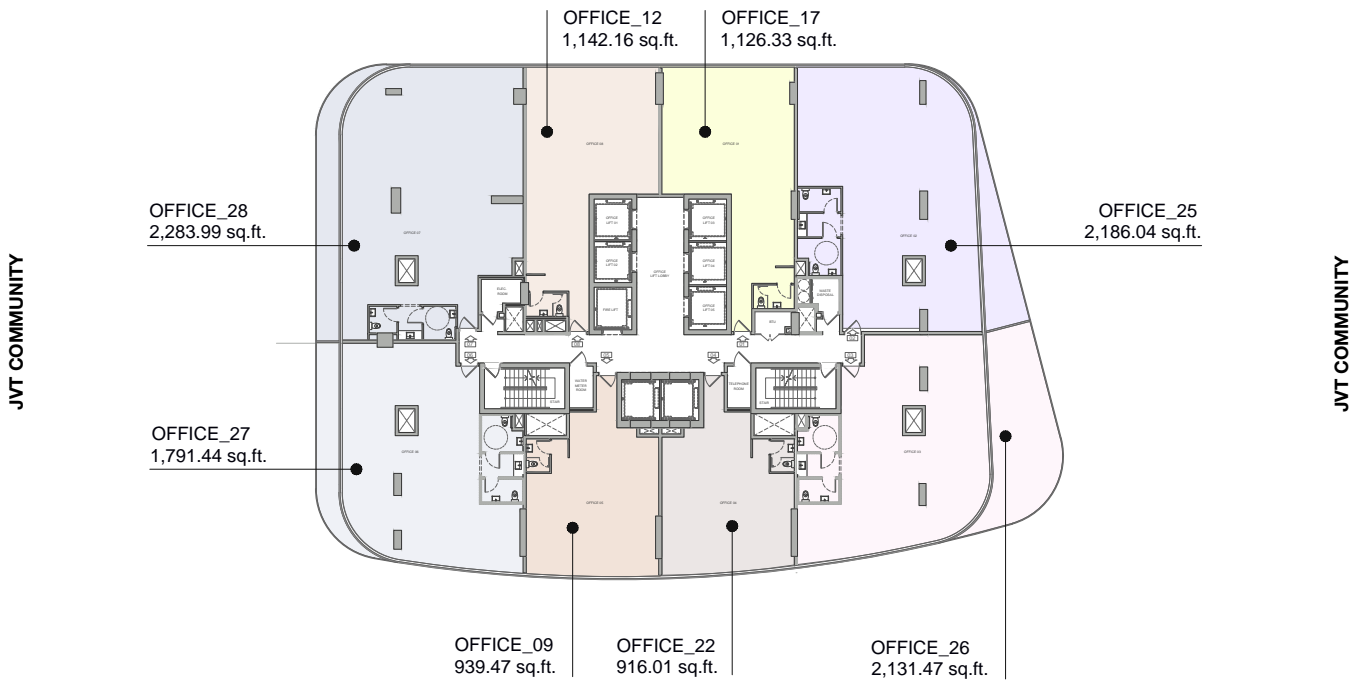

SHEIKH MOHAMMED BIN ZAYED RD (E 311)

Disclaimer: all pictures, plans, layouts, information, data and details included in this brochure are indicative only may change at any time up to the final "as built" status in accordance with the final designs of the project, regulatory approvals and planning permissions

TYPICAL FLOOR
FLOOR: 8

ELARIS
Apex

DUBAI MARINA, JUMEIRAH ISLANDS

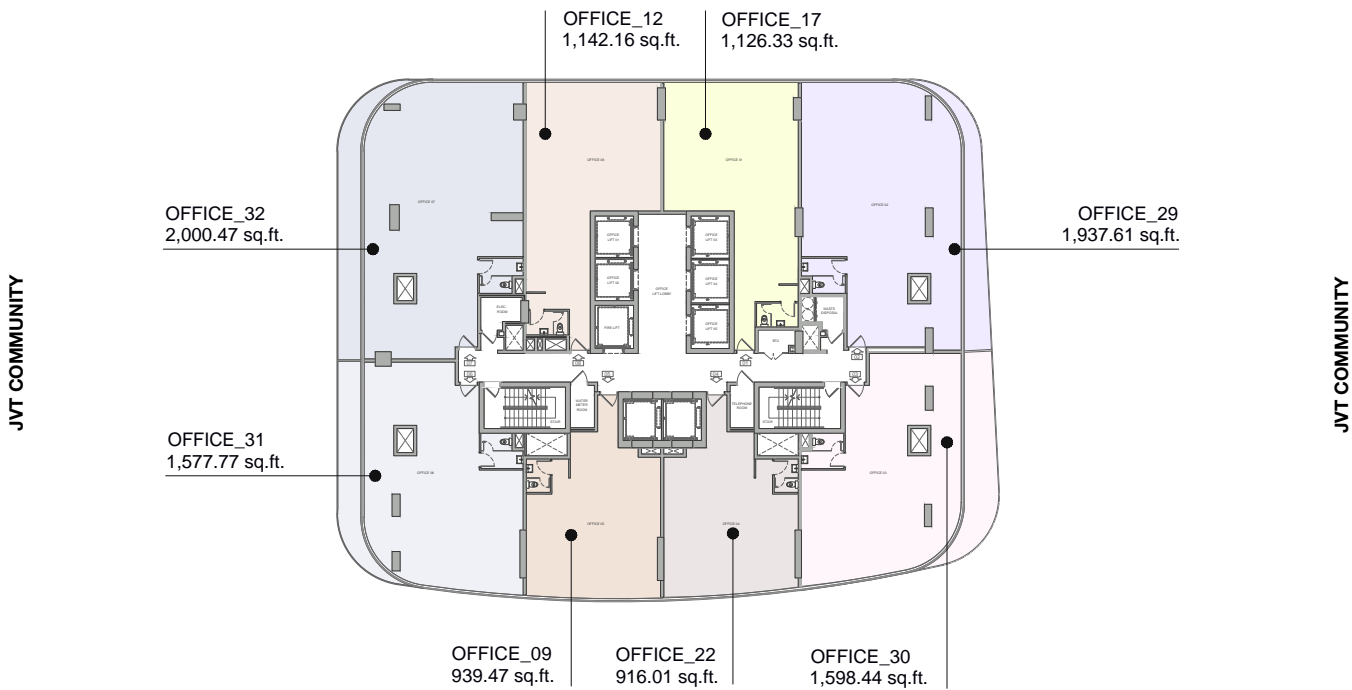

SHEIKH MOHAMMED BIN ZAYED RD (E 311)

Disclaimer: all pictures, plans, layouts, information, data and details included in this brochure are indicative only may change at any time up to the final "as built" status in accordance with the final designs of the project, regulatory approvals and planning permissions

TYPICAL FLOOR
FLOOR: 9-11

ELARIS
Apex

DUBAI MARINA, JUMEIRAH ISLANDS

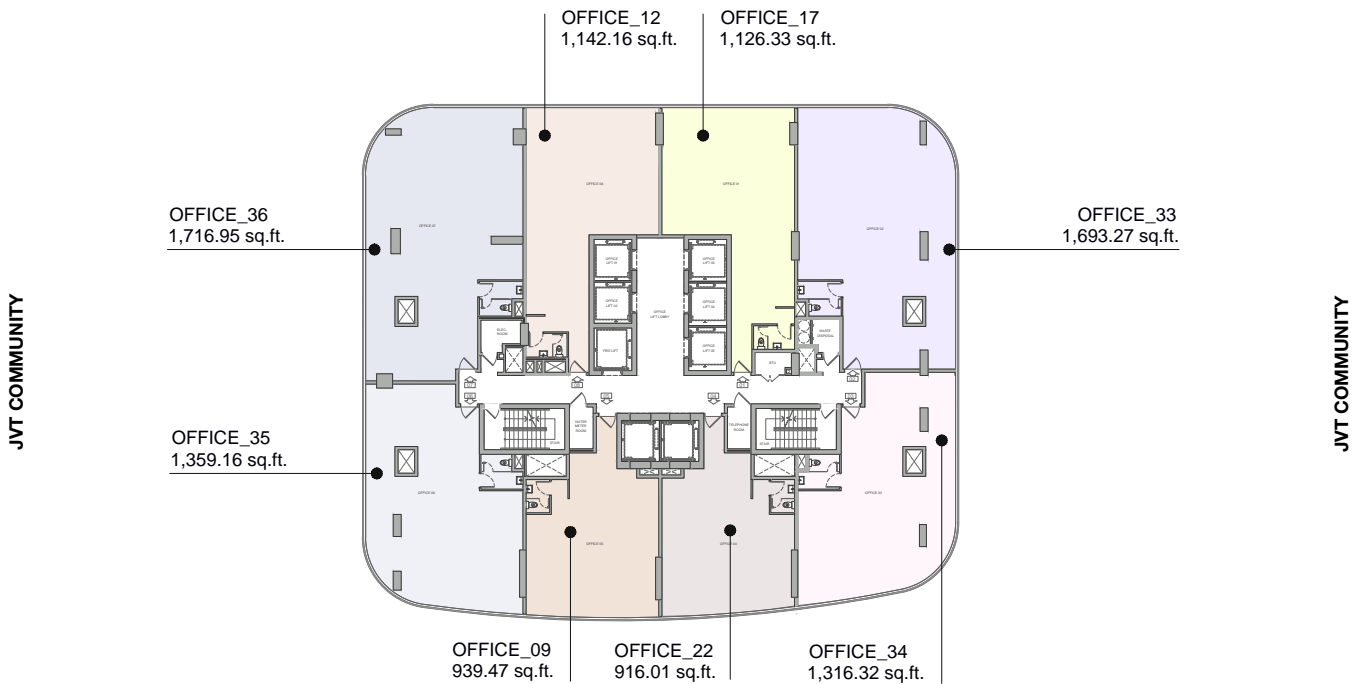

SHEIKH MOHAMMED BIN ZAYED RD (E 311)

Disclaimer: all pictures, plans, layouts, information, data and details included in this brochure are indicative only may change at any time up to the final "as built" status in accordance with the final designs of the project, regulatory approvals and planning permissions

TYPICAL FLOOR
FLOOR: 12

ELARIS
Aras

DUBAI MARINA, JUMEIRAH ISLANDS

JVT COMMUNITY

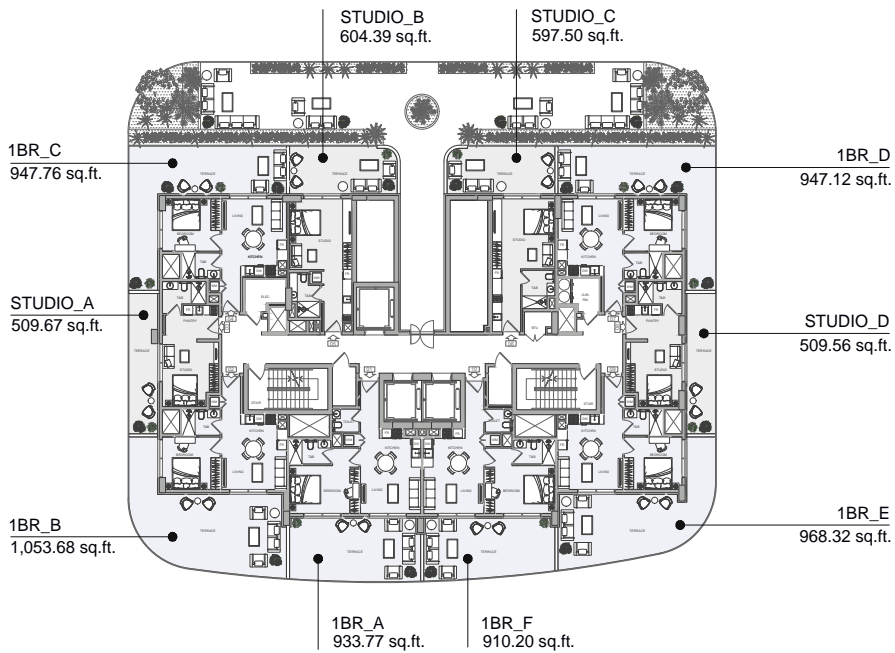

JVT COMMUNITY



SHEIKH MOHAMMED BIN ZAYED RD (E 311)

Disclaimer: all pictures, plans, layouts, information, data and details included in this brochure are indicative only may change at any time up to the final "as built" status in accordance with the final designs of the project, regulatory approvals and planning permissions

TYPICAL FLOOR
FLOOR: 13-18

ELARIS
Apartment

DUBAI MARINA, JUMEIRAH ISLANDS

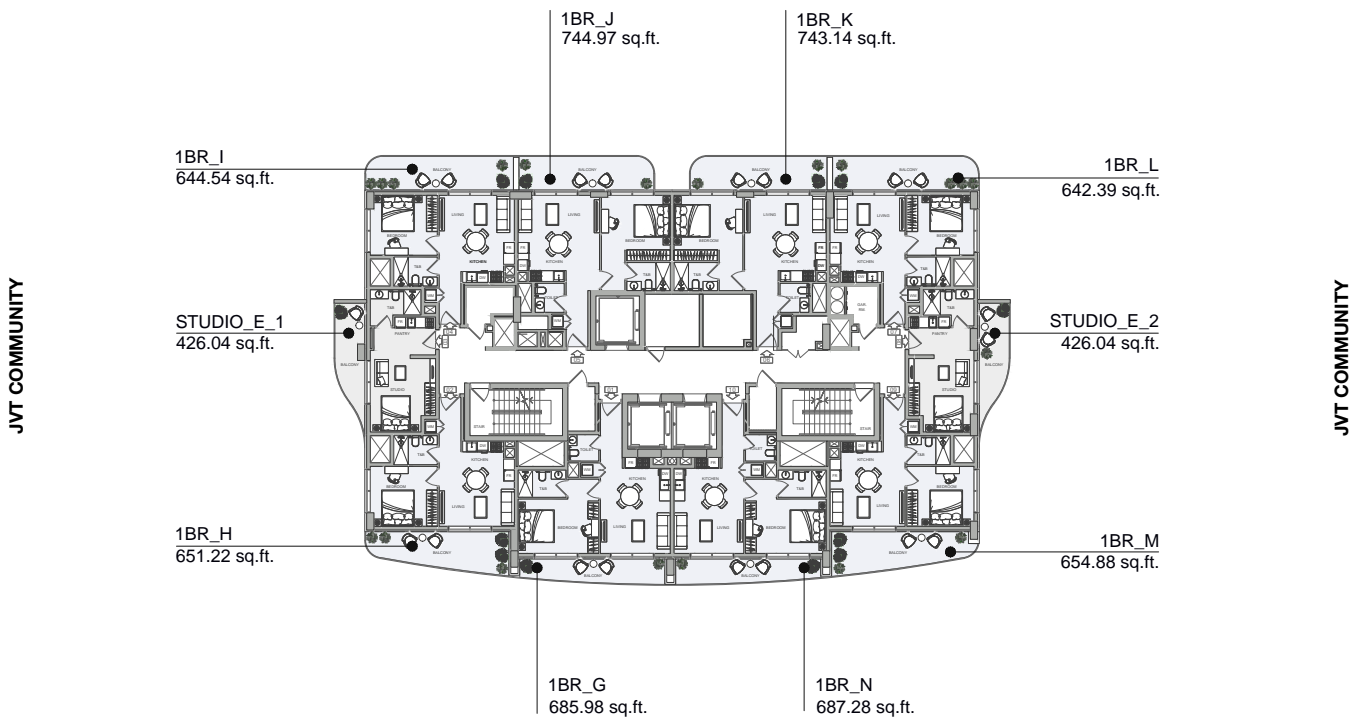

SHEIKH MOHAMMED BIN ZAYED RD (E 311)

ELARIS
Apex

Studio

STUDIO

FLOOR: 12

ELARIS
Apex

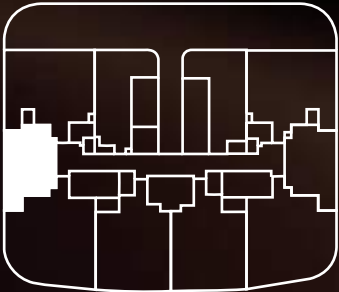

STUDIO TYPE A

| | | |
|---------------------|---------------|--------|
| SUITE AREA | 310.22 | sq. ft |
| BALCONY AREA | 199.46 | sq. ft |
| TOTAL SELLABLE AREA | 509.67 | sq. ft |

Disclaimer: all pictures, plans, layouts, information, data and details included in this brochure are indicative only may change at any time up to the final "as built" status in accordance with the final designs of the project, regulatory approvals and planning permissions

STUDIO

FLOOR: 12

ELARIS
Apartment

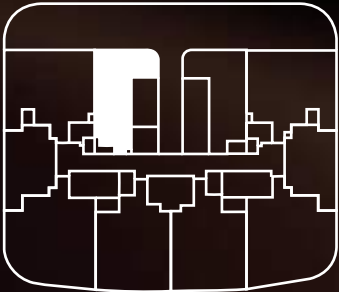

STUDIO TYPE B

| | | |
|---------------------|--------|--------|
| SUITE AREA | 361.02 | sq. ft |
| BALCONY AREA | 243.37 | sq. ft |
| TOTAL SELLABLE AREA | 604.39 | sq. ft |

STUDIO

FLOOR: 12

ELARIS
Apartment

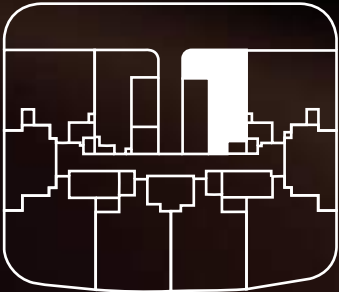

STUDIO TYPE C

| | | |
|---------------------|--------|--------|
| SUITE AREA | 354.13 | sq. ft |
| BALCONY AREA | 243.37 | sq. ft |
| TOTAL SELLABLE AREA | 597.50 | sq. ft |

Disclaimer: all pictures, plans, layouts, information, data and details included in this brochure are indicative only may change at any time up to the final "as built" status in accordance with the final designs of the project, regulatory approvals and planning permissions

STUDIO

FLOOR: 12

ELARIS
Apartment

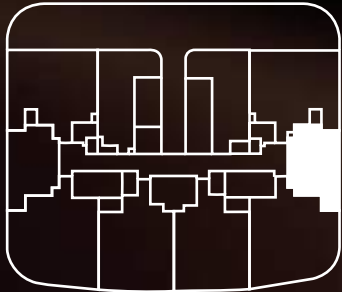

STUDIO TYPE D

| | | |
|---------------------|---------------|--------|
| SUITE AREA | 310.22 | sq. ft |
| BALCONY AREA | 199.35 | sq. ft |
| TOTAL SELLABLE AREA | 509.56 | sq. ft |

Disclaimer: all pictures, plans, layouts, information, data and details included in this brochure are indicative only may change at any time up to the final "as built" status in accordance with the final designs of the project, regulatory approvals and planning permissions

STUDIO

FLOOR: 13-18

ELARIS
Apartment

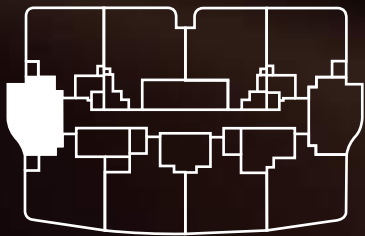

STUDIO TYPE E_1

| | | |
|---------------------|--------|--------|
| SUITE AREA | 310.22 | sq. ft |
| BALCONY AREA | 115.82 | sq. ft |
| TOTAL SELLABLE AREA | 426.04 | sq. ft |

Disclaimer: all pictures, plans, layouts, information, data and details included in this brochure are indicative only may change at any time up to the final "as built" status in accordance with the final designs of the project, regulatory approvals and planning permissions

STUDIO

FLOOR: 13-18

ELARIS
Apartment

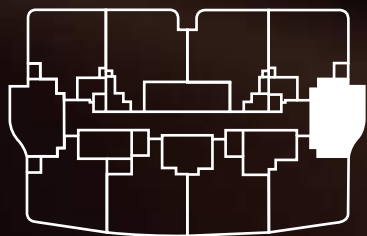

STUDIO TYPE E_2

| | | |
|---------------------|--------|--------|
| SUITE AREA | 310.22 | sq. ft |
| BALCONY AREA | 115.82 | sq. ft |
| TOTAL SELLABLE AREA | 426.04 | sq. ft |

Disclaimer: all pictures, plans, layouts, information, data and details included in this brochure are indicative only may change at any time up to the final "as built" status in accordance with the final designs of the project, regulatory approvals and planning permissions

One Bedroom

ONE BEDROOM
FLOOR: 12

ELARIS
Apartment

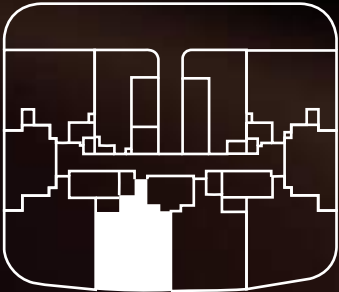

1 BR TYPE A

| | | |
|---------------------|--------|--------|
| SUITE AREA | 551.11 | sq. ft |
| BALCONY AREA | 382.66 | sq. ft |
| TOTAL SELLABLE AREA | 933.77 | sq. ft |

Disclaimer: all pictures, plans, layouts, information, data and details included in this brochure are indicative only may change at any time up to the final "as built" status in accordance with the final designs of the project, regulatory approvals and planning permissions

ONE BEDROOM

FLOOR: 12

ELARIS
Apartment

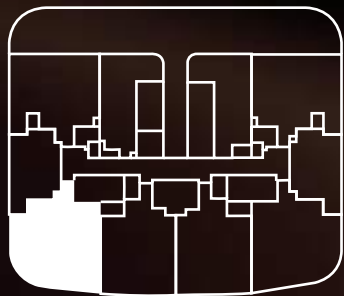

1 BR TYPE B

| | | |
|---------------------|----------|--------|
| SUITE AREA | 56.12 | sq. ft |
| BALCONY AREA | 591.69 | sq. ft |
| TOTAL SELLABLE AREA | 1,053.68 | sq. ft |

Disclaimer: all pictures, plans, layouts, information, data and details included in this brochure are indicative only may change at any time up to the final "as built" status in accordance with the final designs of the project, regulatory approvals and planning permissions

ONE BEDROOM

FLOOR: 12

ELARIS
Apartment

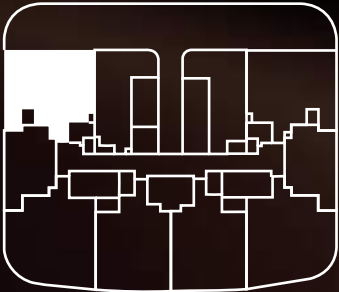

1 BR TYPE C

| | | |
|---------------------|--------|--------|
| SUITE AREA | 463.17 | sq. ft |
| BALCONY AREA | 484.59 | sq. ft |
| TOTAL SELLABLE AREA | 947.76 | sq. ft |

Disclaimer: all pictures, plans, layouts, information, data and details included in this brochure are indicative only may change at any time up to the final "as built" status in accordance with the final designs of the project, regulatory approvals and planning permissions

ONE BEDROOM

FLOOR: 12

ELARIS
Apartment

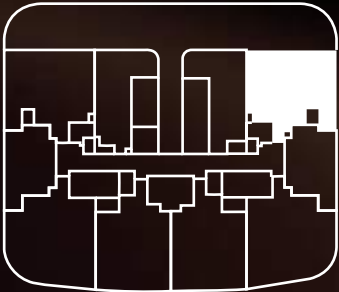

1 BR TYPE D

| | | |
|---------------------|--------|--------|
| SUITE AREA | 462.52 | sq. ft |
| BALCONY AREA | 484.59 | sq. ft |
| TOTAL SELLABLE AREA | 947.12 | sq. ft |

Disclaimer: all pictures, plans, layouts, information, data and details included in this brochure are indicative only may change at any time up to the final "as built" status in accordance with the final designs of the project, regulatory approvals and planning permissions

ONE BEDROOM

FLOOR: 12

ELARIS
Apartment

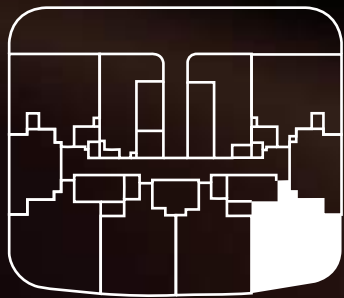

1 BR TYPE E

| | | |
|---------------------|--------|--------|
| SUITE AREA | 461.99 | sq. ft |
| BALCONY AREA | 506.33 | sq. ft |
| TOTAL SELLABLE AREA | 968.32 | sq. ft |

Disclaimer: all pictures, plans, layouts, information, data and details included in this brochure are indicative only may change at any time up to the final "as built" status in accordance with the final designs of the project, regulatory approvals and planning permissions

ONE BEDROOM

FLOOR: 12

ELARIS
Apartment

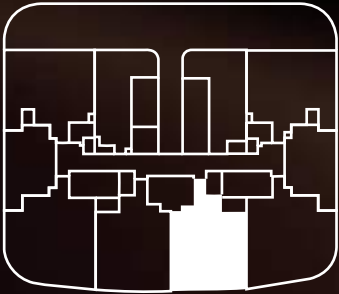

1 BR TYPE F

| | | |
|---------------------|--------|--------|
| SUITE AREA | 551.11 | sq. ft |
| BALCONY AREA | 359.08 | sq. ft |
| TOTAL SELLABLE AREA | 910.20 | sq. ft |

Disclaimer: all pictures, plans, layouts, information, data and details included in this brochure are indicative only may change at any time up to the final "as built" status in accordance with the final designs of the project, regulatory approvals and planning permissions

ONE BEDROOM

FLOOR: 13-18

ELARIS
Apartment

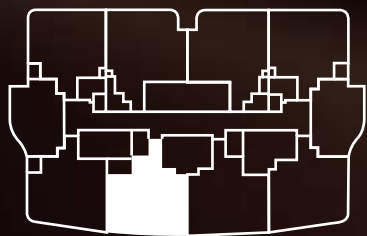

1 BR TYPE G

| | | |
|---------------------|--------|--------|
| SUITE AREA | 551.11 | sq. ft |
| BALCONY AREA | 134.87 | sq. ft |
| TOTAL SELLABLE AREA | 685.98 | sq. ft |

Disclaimer: all pictures, plans, layouts, information, data and details included in this brochure are indicative only may change at any time up to the final "as built" status in accordance with the final designs of the project, regulatory approvals and planning permissions

ONE BEDROOM

FLOOR: 13-18

ELARIS
Apartment

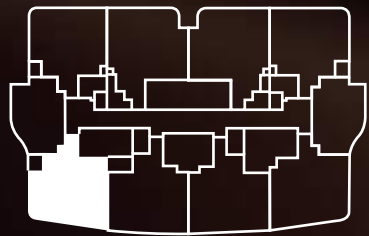

1 BR TYPE H

| | | |
|---------------------|--------|--------|
| SUITE AREA | 460.91 | sq. ft |
| BALCONY AREA | 190.31 | sq. ft |
| TOTAL SELLABLE AREA | 651.22 | sq. ft |

ONE BEDROOM

FLOOR: 13-18

ELARIS
Apartment

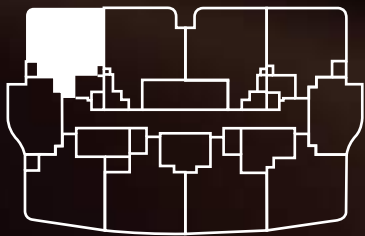

1 BR TYPE I

| | | |
|---------------------|--------|--------|
| SUITE AREA | 462.52 | sq. ft |
| BALCONY AREA | 182.02 | sq. ft |
| TOTAL SELLABLE AREA | 644.54 | sq. ft |

Disclaimer: all pictures, plans, layouts, information, data and details included in this brochure are indicative only may change at any time up to the final "as built" status in accordance with the final designs of the project, regulatory approvals and planning permissions

ONE BEDROOM

FLOOR: 13-18

ELARIS
Apartment

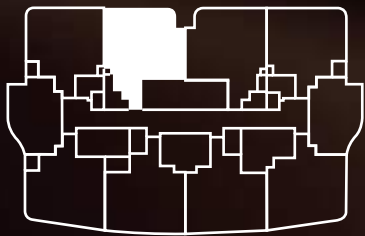

1 BR TYPE J

| | | |
|---------------------|--------|--------|
| SUITE AREA | 580.07 | sq. ft |
| BALCONY AREA | 164.90 | sq. ft |
| TOTAL SELLABLE AREA | 744.97 | sq. ft |

ONE BEDROOM

FLOOR: 13-18

ELARIS
Apartment

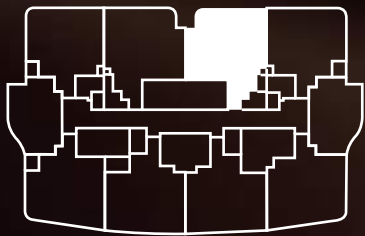

1 BR TYPE K

| | | |
|---------------------|--------|--------|
| SUITE AREA | 575.98 | sq. ft |
| BALCONY AREA | 167.16 | sq. ft |
| TOTAL SELLABLE AREA | 743.14 | sq. ft |

ONE BEDROOM

FLOOR: 13-18

ELARIS
Apartment

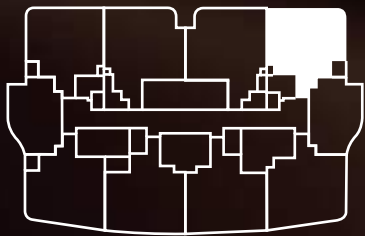

1 BR TYPE L

| | | |
|---------------------|--------|--------|
| SUITE AREA | 462.52 | sq. ft |
| BALCONY AREA | 179.86 | sq. ft |
| TOTAL SELLABLE AREA | 642.39 | sq. ft |

Disclaimer: all pictures, plans, layouts, information, data and details included in this brochure are indicative only may change at any time up to the final "as built" status in accordance with the final designs of the project, regulatory approvals and planning permissions

ONE BEDROOM

FLOOR: 13-18

ELARIS
Apartment

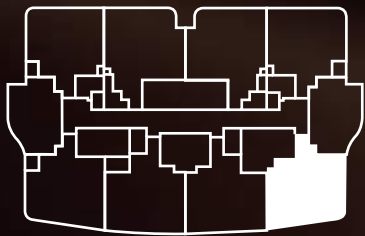

1 BR TYPE M

| | | |
|---------------------|--------|--------|
| SUITE AREA | 461.99 | sq. ft |
| BALCONY AREA | 192.89 | sq. ft |
| TOTAL SELLABLE AREA | 654.88 | sq. ft |

Disclaimer: all pictures, plans, layouts, information, data and details included in this brochure are indicative only may change at any time up to the final "as built" status in accordance with the final designs of the project, regulatory approvals and planning permissions

ONE BEDROOM

FLOOR: 13-18

ELARIS
Apartment

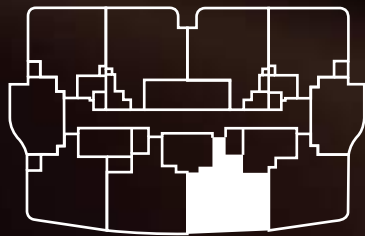

1 BR TYPE N

| | | |
|---------------------|--------|--------|
| SUITE AREA | 551.54 | sq. ft |
| BALCONY AREA | 135.73 | sq. ft |
| TOTAL SELLABLE AREA | 687.28 | sq. ft |

Object 1